

A detailed pencil sketch of a hand holding a pen, rendered in a light, sketchy style. The hand is positioned as if writing, with the pen held between the fingers. The sketch uses fine lines and cross-hatching to create shading and texture, particularly on the hand and the pen. The overall composition is centered, with the hand and pen occupying most of the frame.

PORTFOLIO

BRIAN LOPEZ

2023

TABLE OF CONTENTS

Studio 1	
Intro to Architecture	4
Studio 2	
Kennesaw Study Space	10
DCOM 2	
Jinwa Mountain Cottage Precedent	16
Studio 3	
Multifamily Development	20
Studio 4	
Marietta Square Pavillion	24
Marietta Izakaya Restaurant	28
Fernando Botero Gallery	34



Intro to Architecture Studio 1

Through exercises and projects, it introduces a variety of skills and fundamental principles in design for the beginning student in architecture including but not limited to the following: graphic observations, analysis, and representations, design process, architectural drawing and drafting, model building, and verbal communication

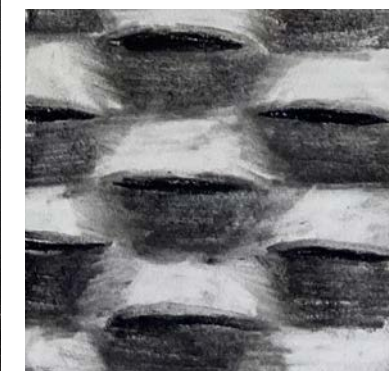
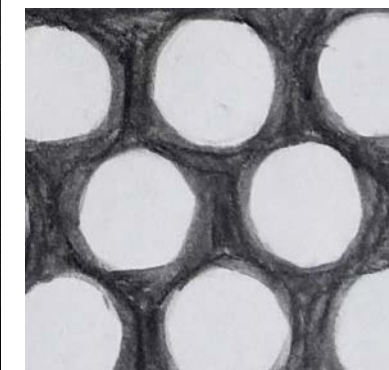
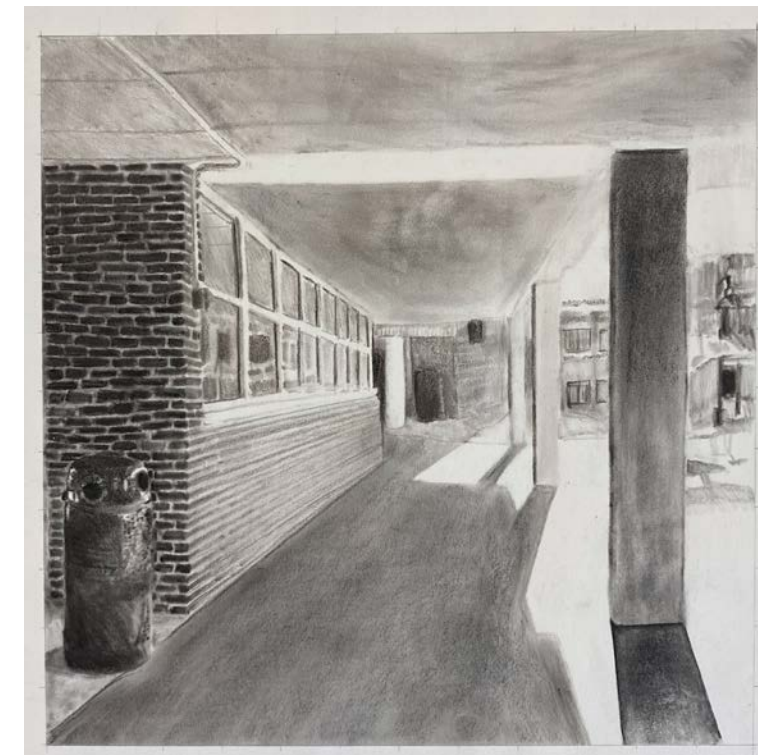

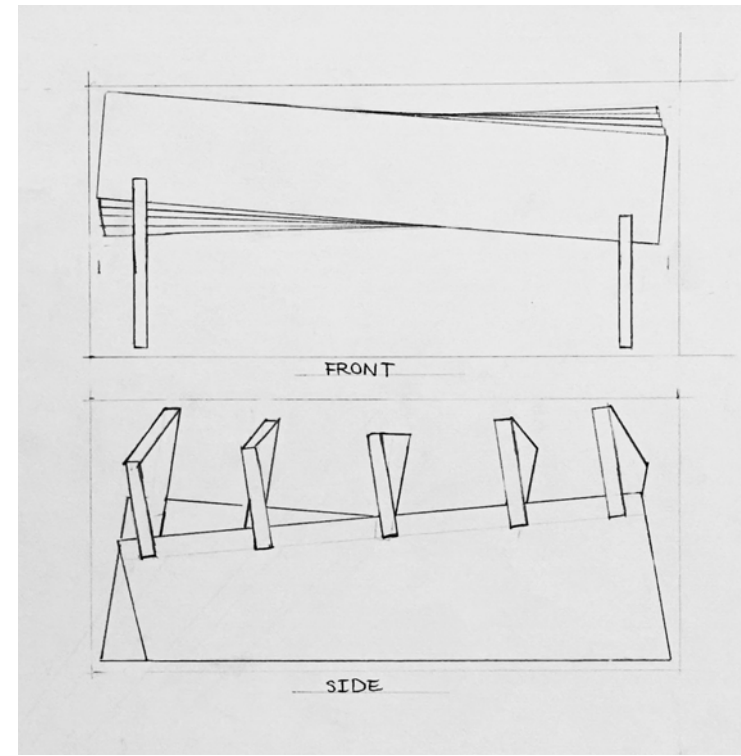
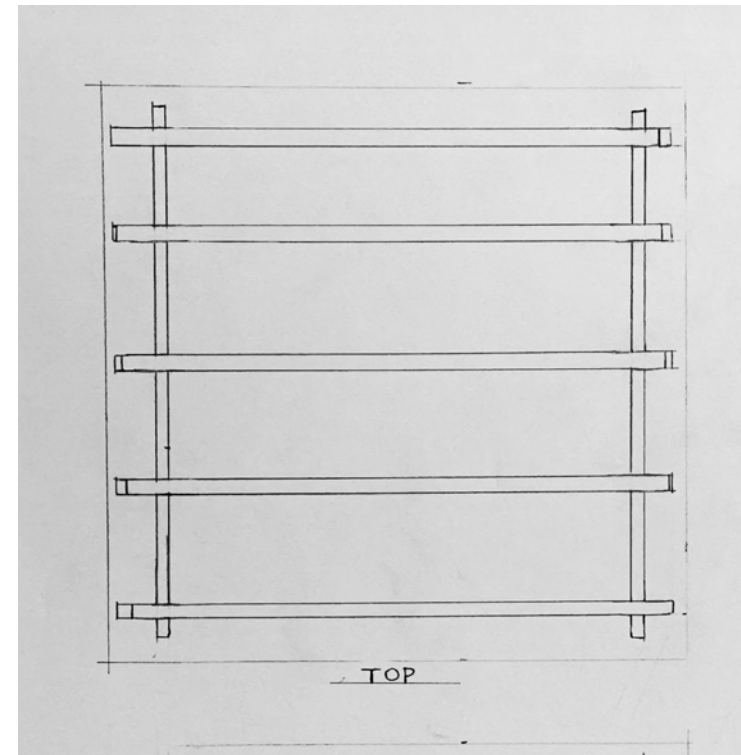
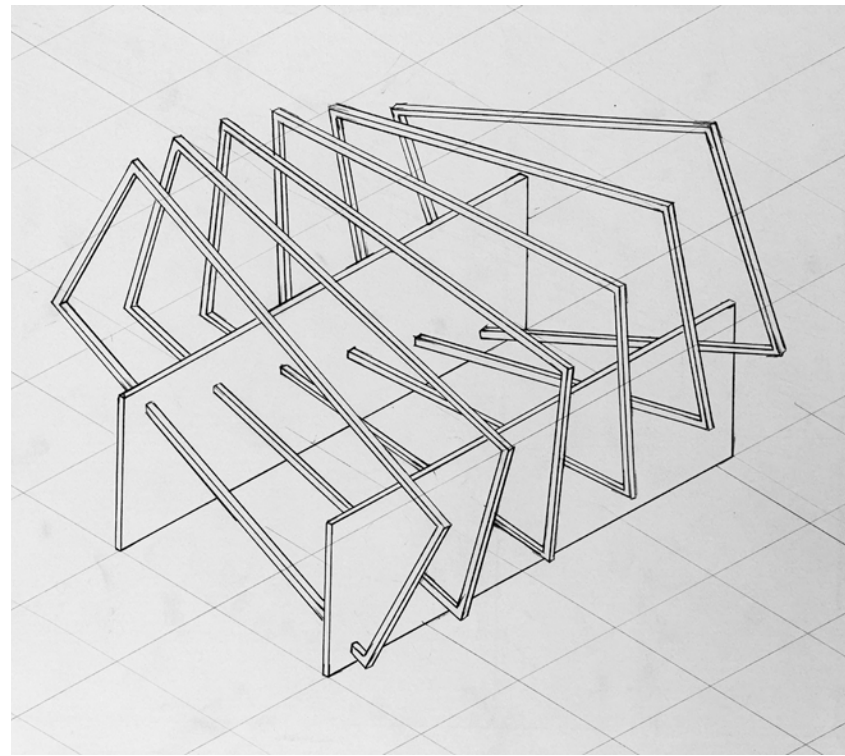
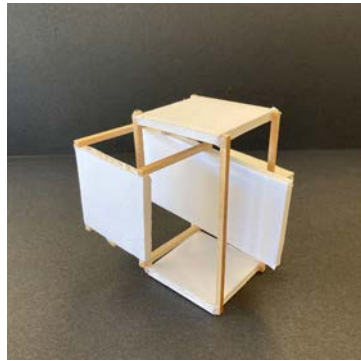
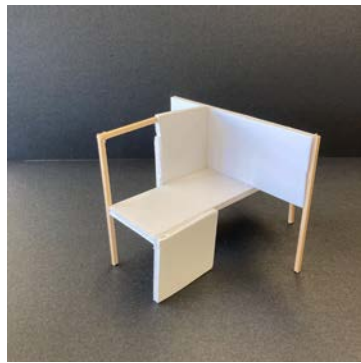
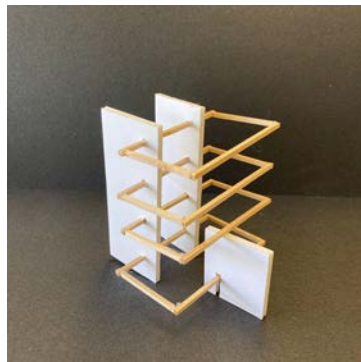
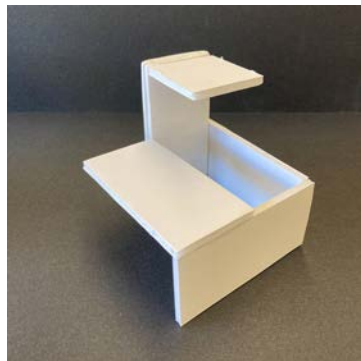

Throughout my architectural studies, I learned to create spaces by studying materials and creating study models. This process allowed me to experiment with different approaches and gain a deeper understanding of the role that materials play in design. Through orthographic drawings, I was able to translate my ideas into detailed plans and develop my technical skills.

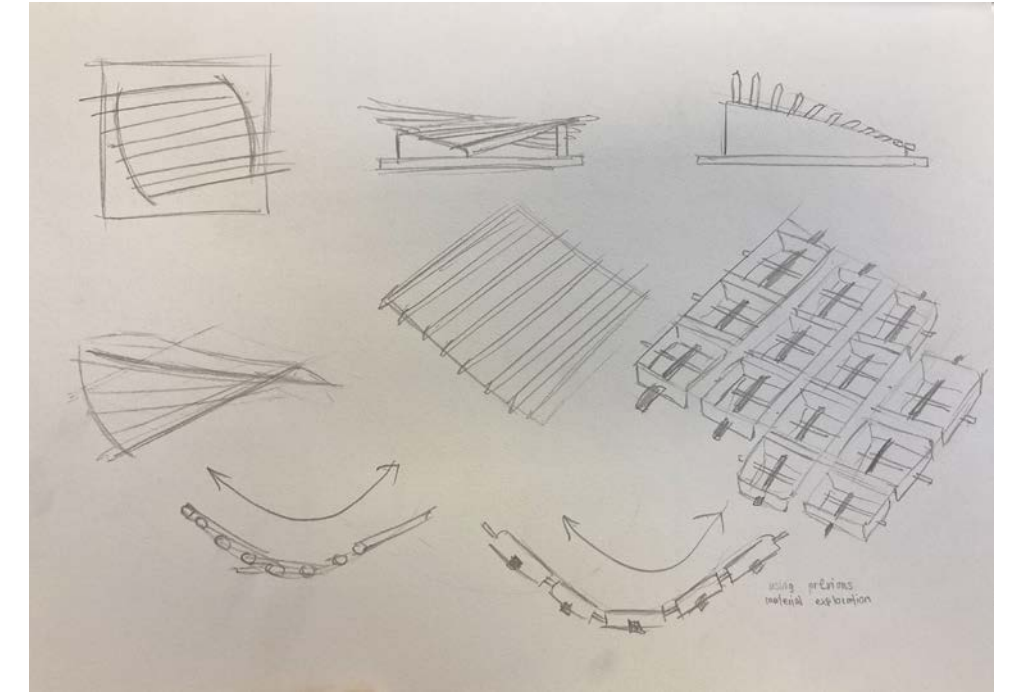

MATERIAL INVESTIGATION

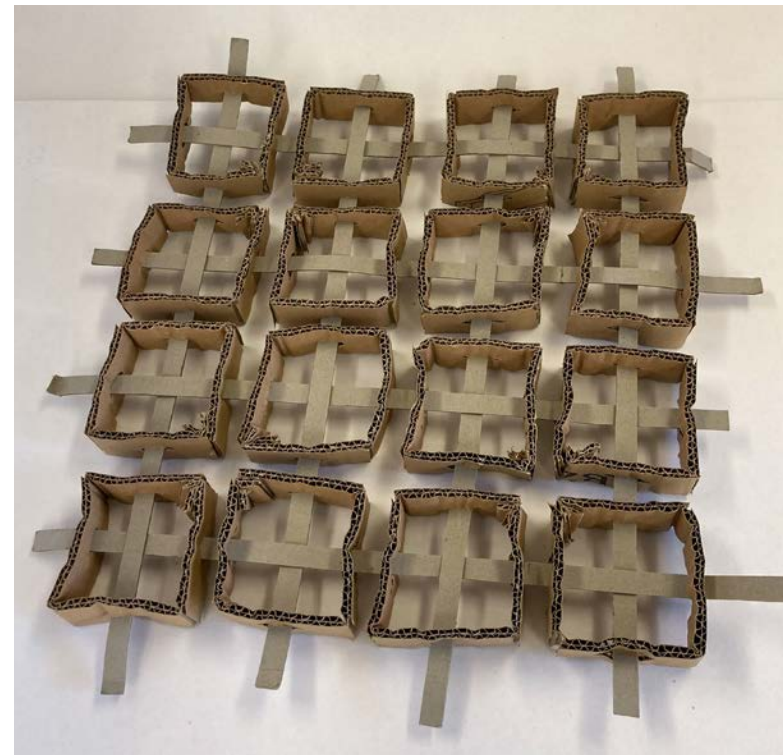

I was tasked on creating a pavillion space using my knowledge of materials, design principles, and technical skills. After much experimentation and iteration, I finally arrived at a design that felt truly unique and reflective of my personal style. The resulting pavillion was dynamic space that had a sense of openness and lightness. Through this project, I learned to think more critically about my design choices and how to translate my individual skills into a cohesive space.

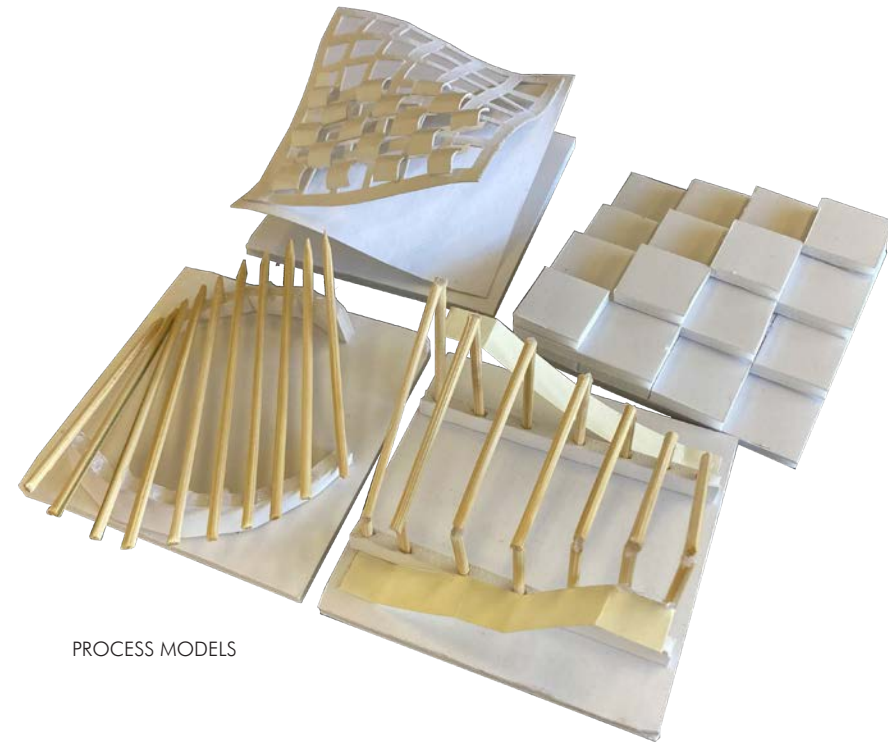
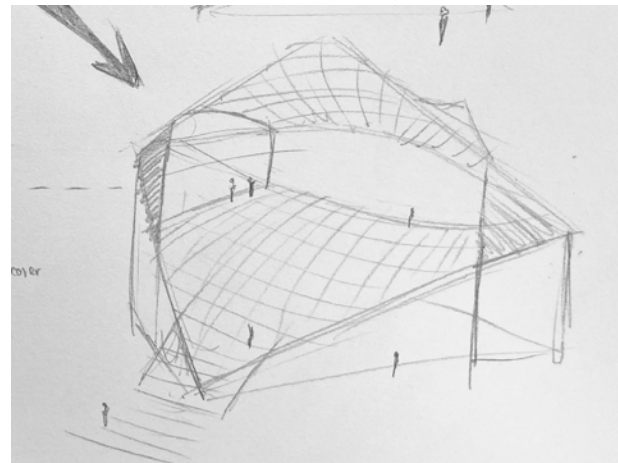
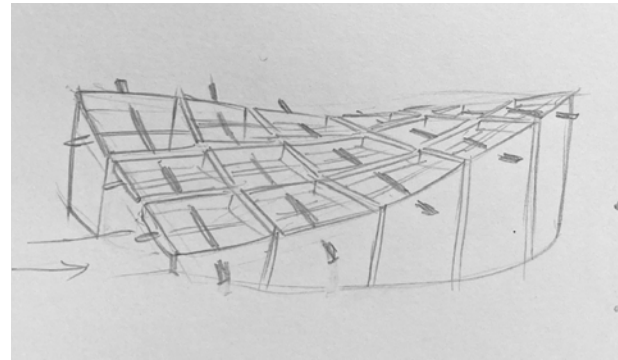
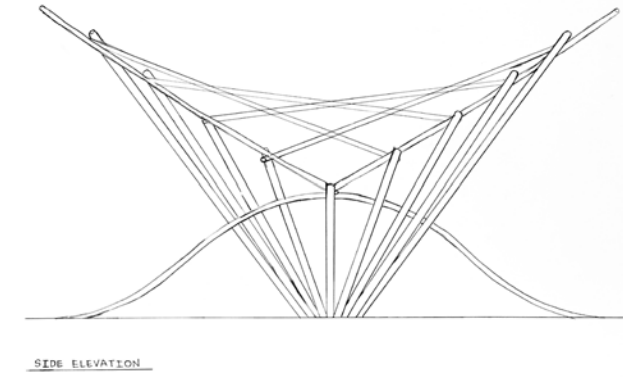
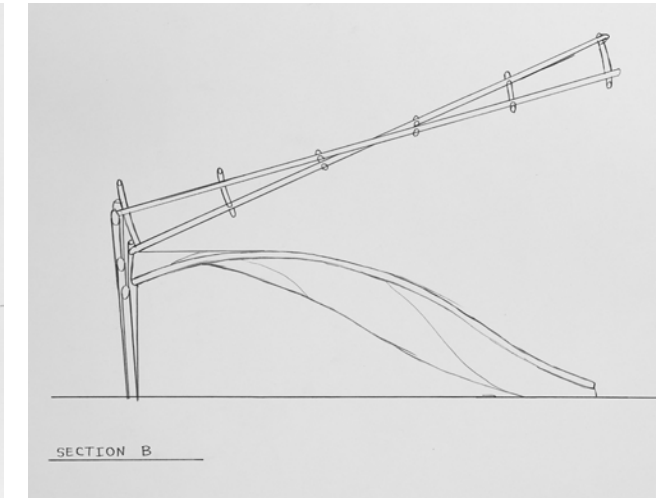
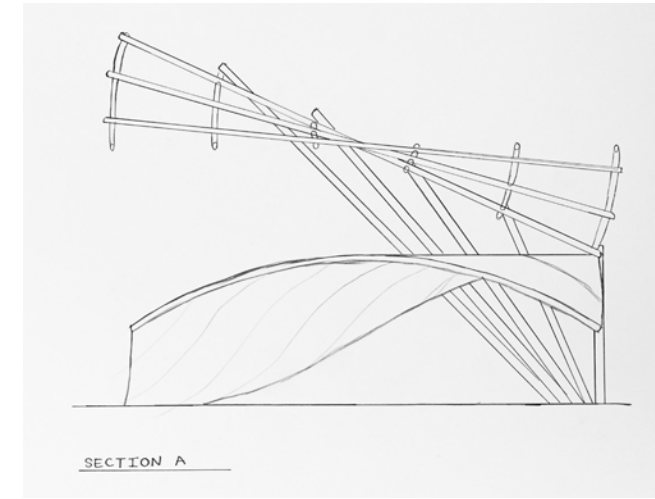
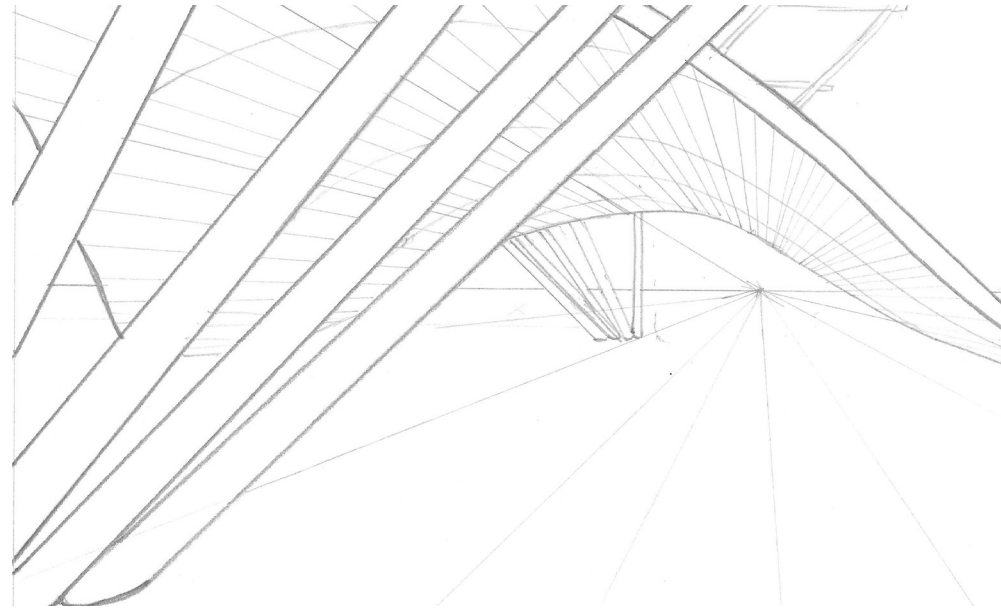

PROCESS MODELS

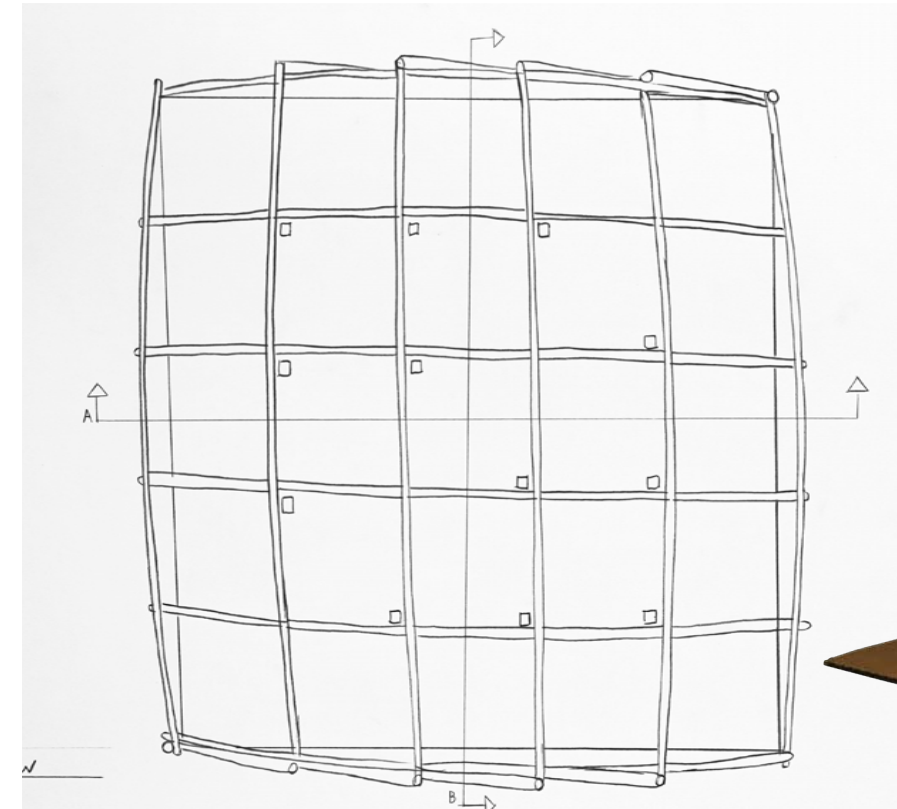

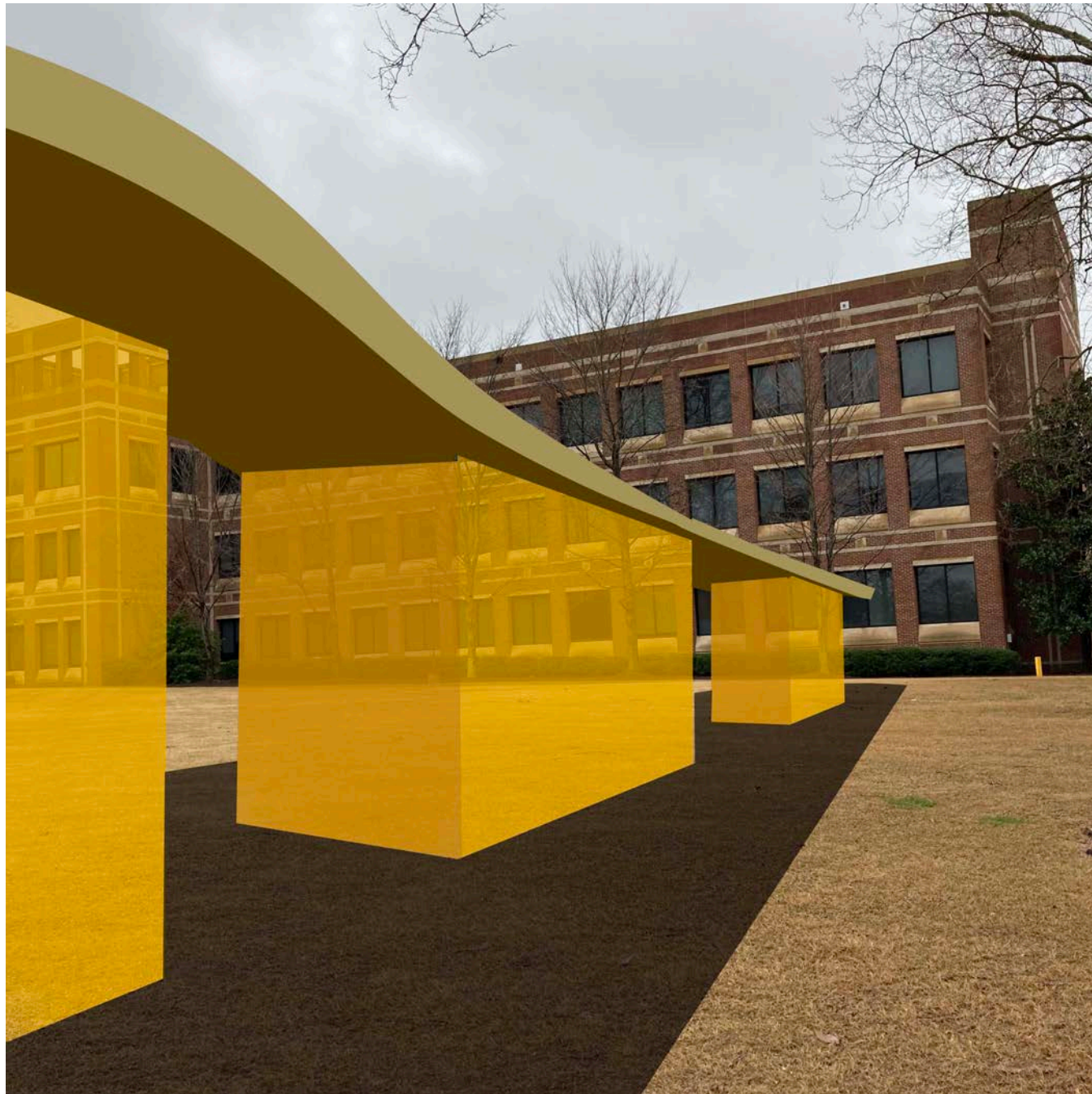

Study Space Studio 2

I was challenged to create a study space that would be a part of the KSU campus. To begin the project, I thoroughly analyzed the site taking into account several factors. Drawing on what I had learned in previous coursework, I set out to create a space that would be both functional and interesting for students. Through this project, I learned to think more deeply about the relationship between a building and its surroundings, and how to create a space that truly serves its intended purpose.

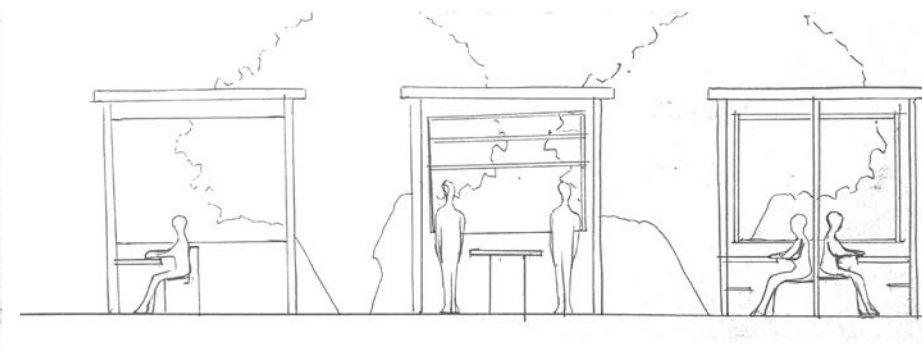
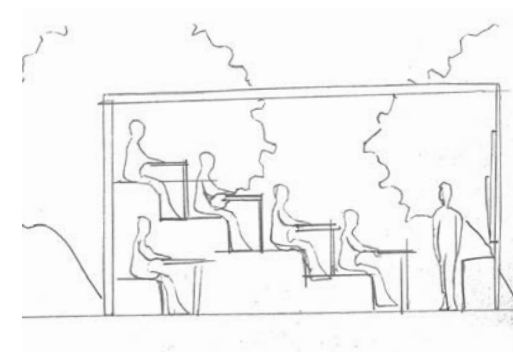
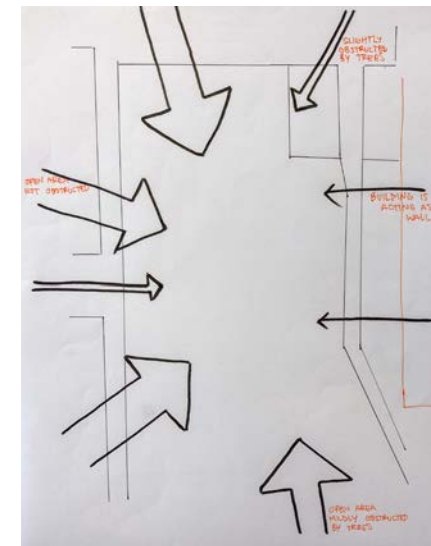
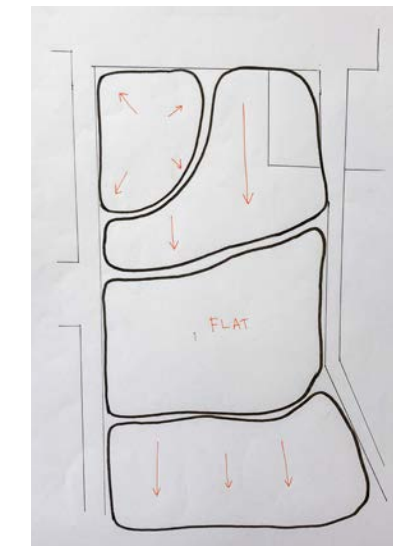
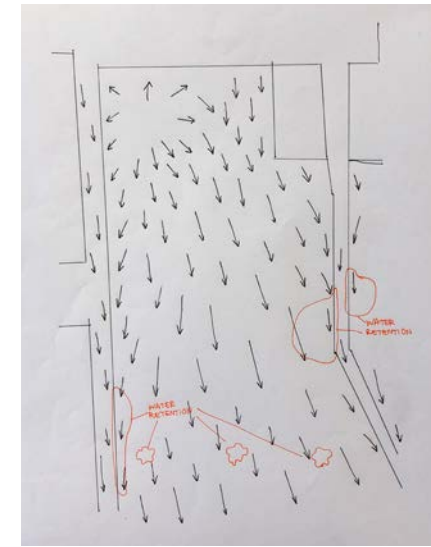
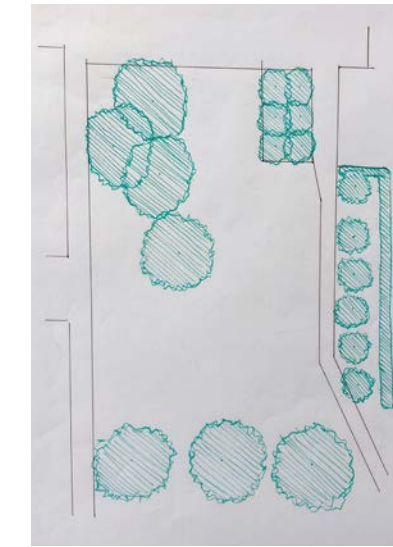

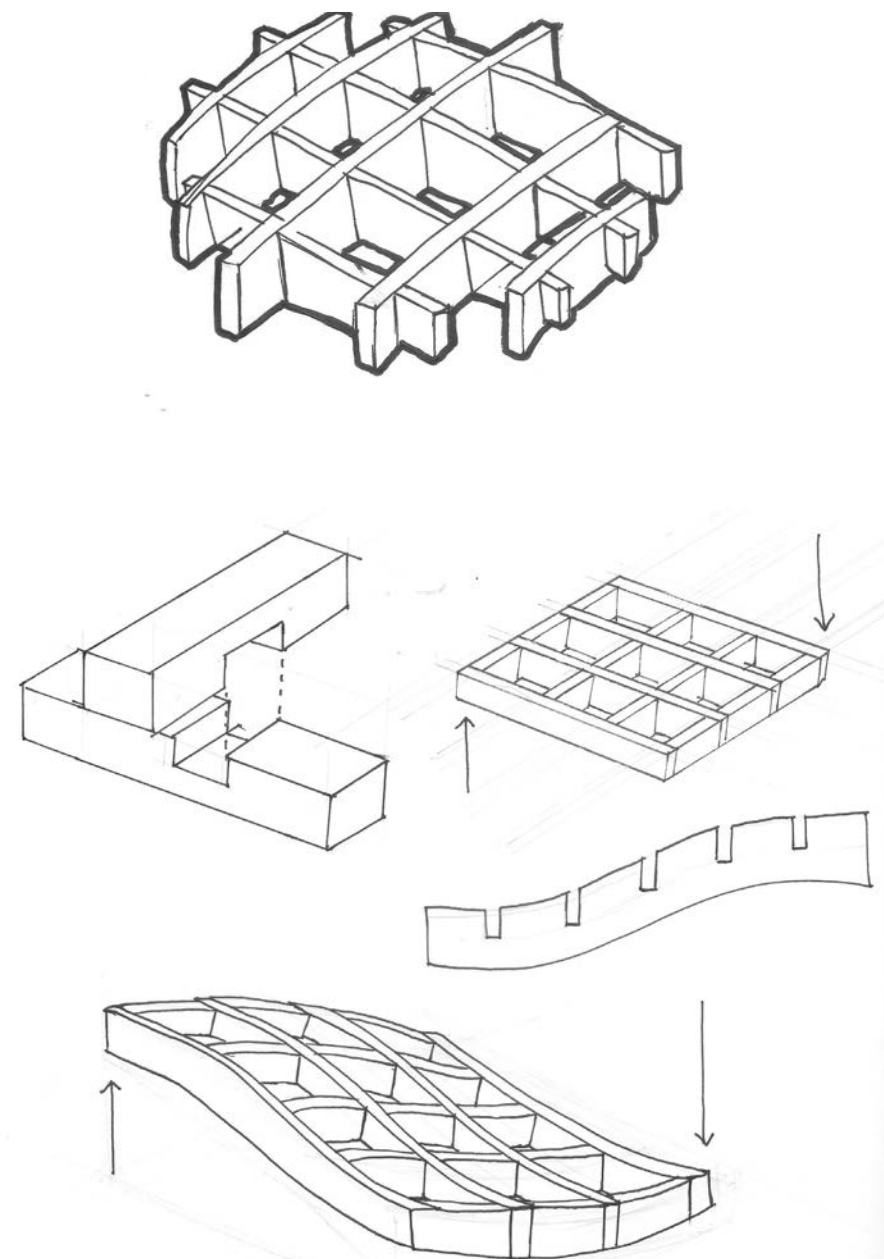
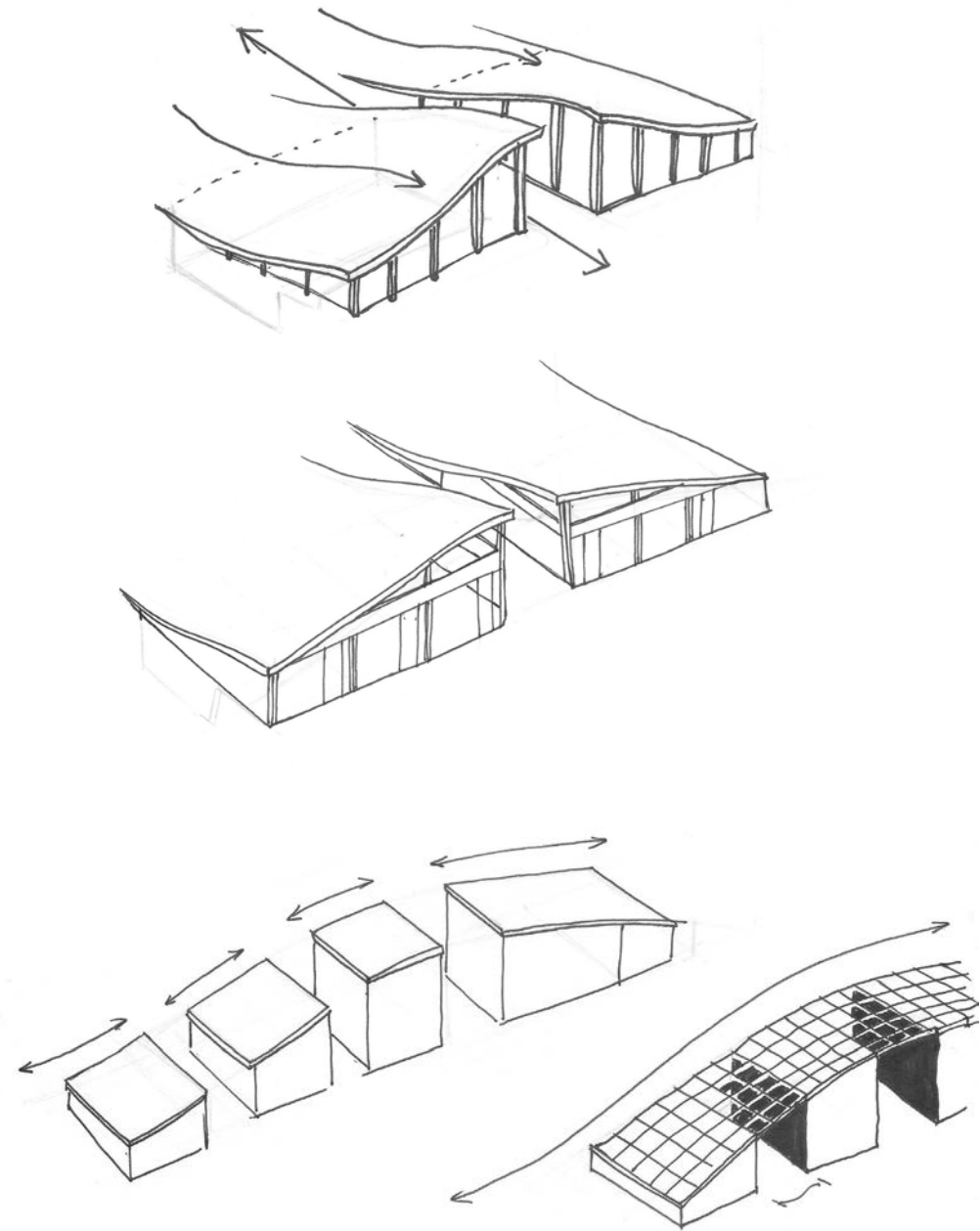
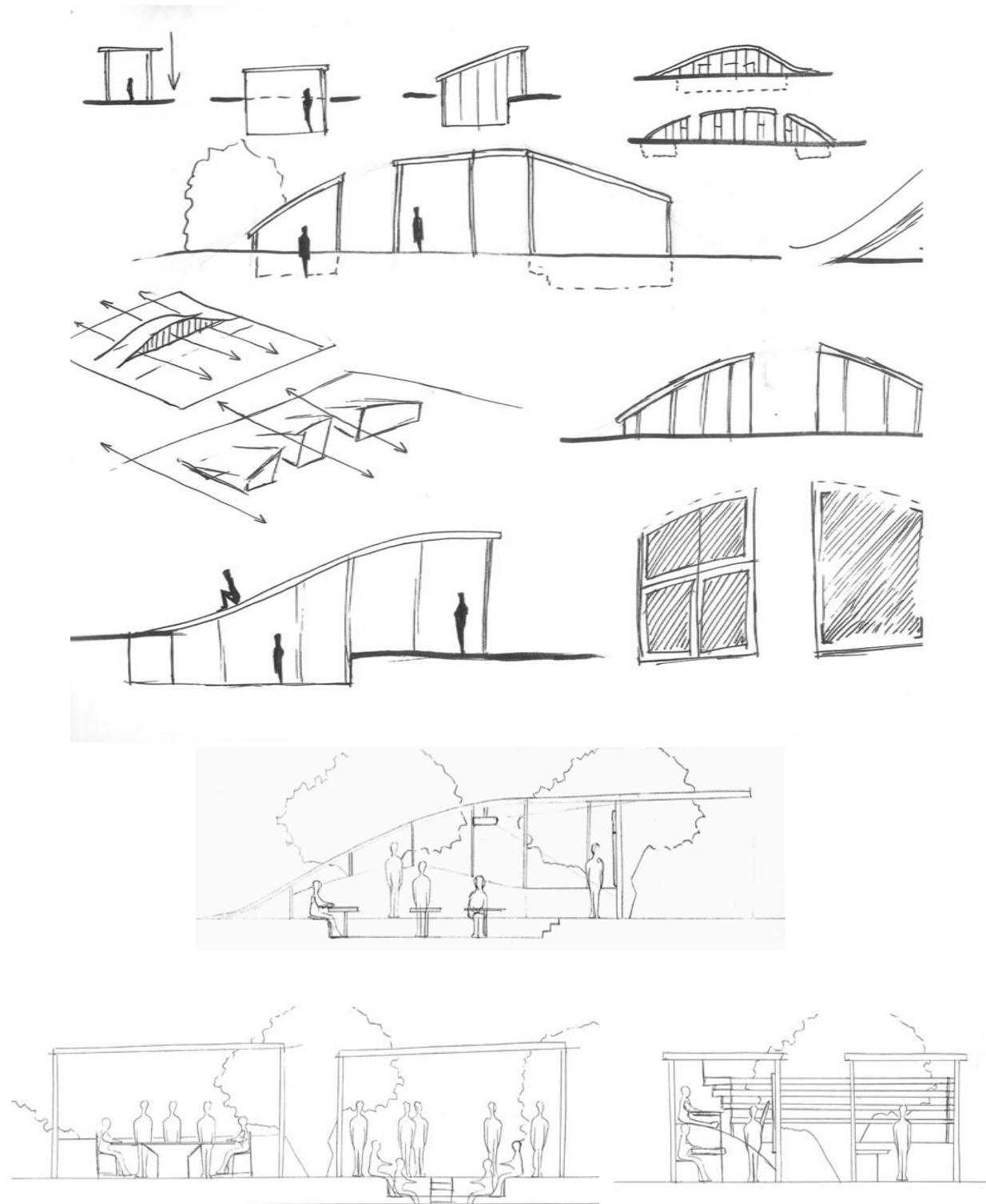
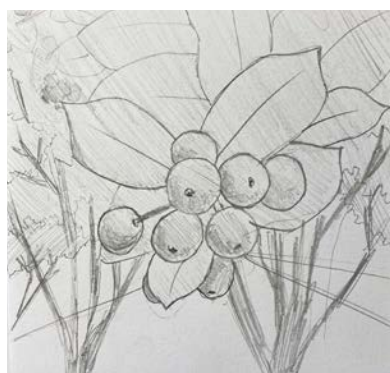
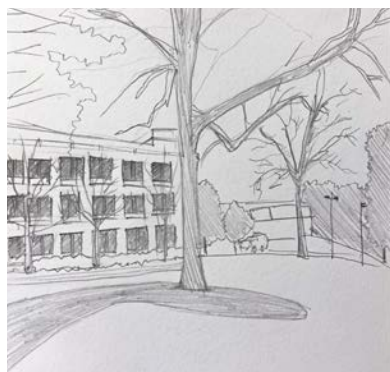
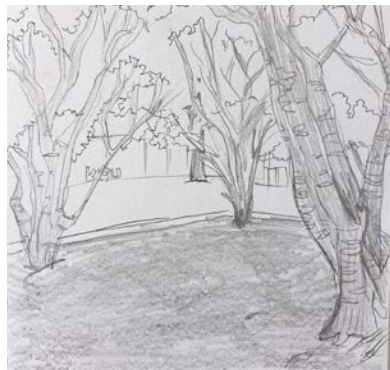

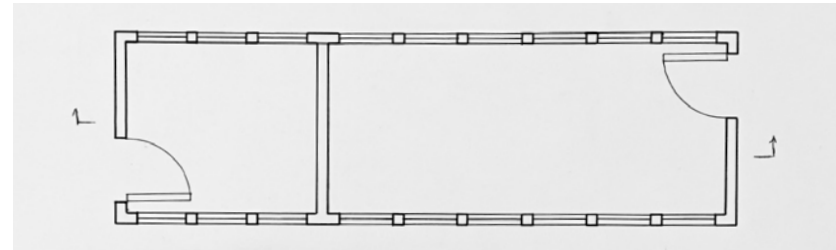

LARGE STUDY SPACE PLAN

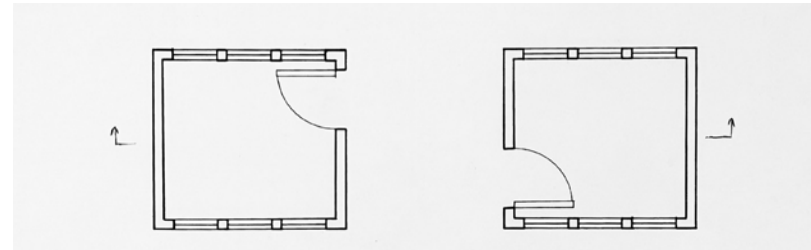

SMALL STUDY SPACE PLAN

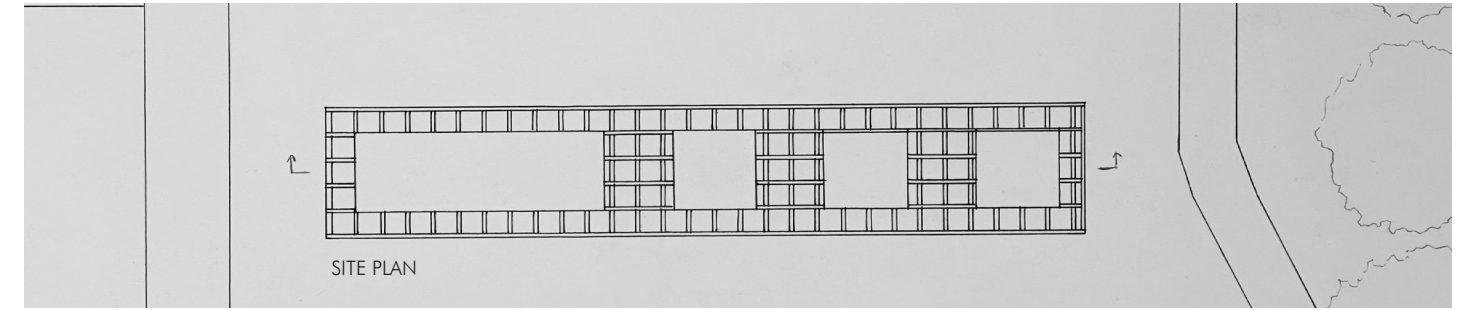

SITE PLAN

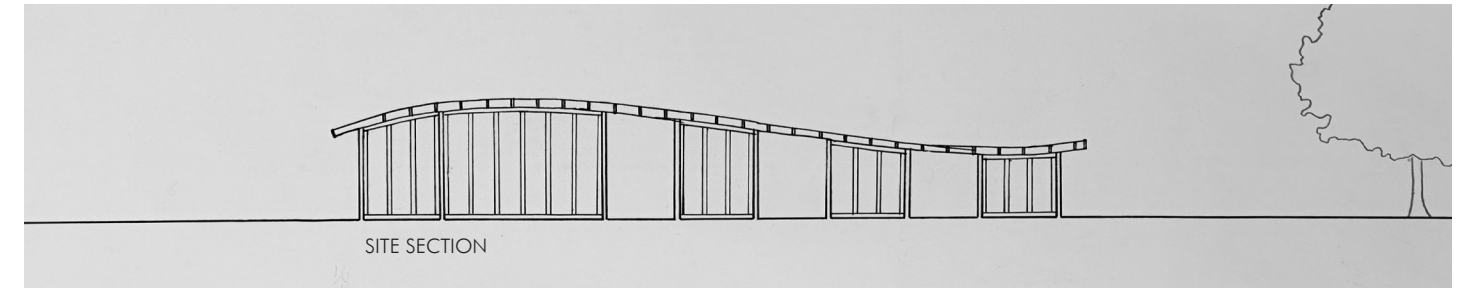

SITE SECTION

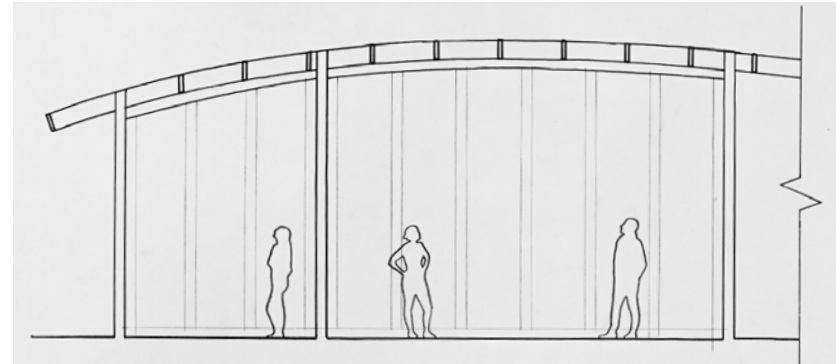

NORTH SECTION

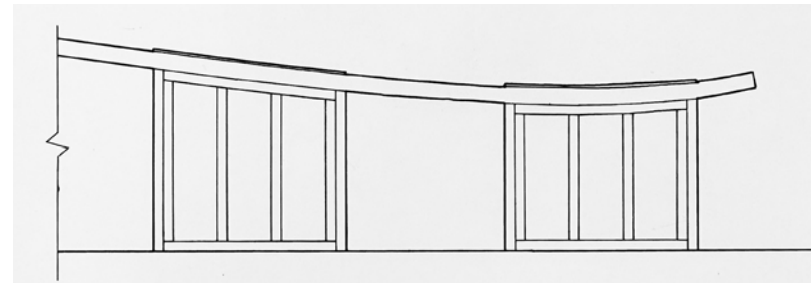

NORTH ELEVATION

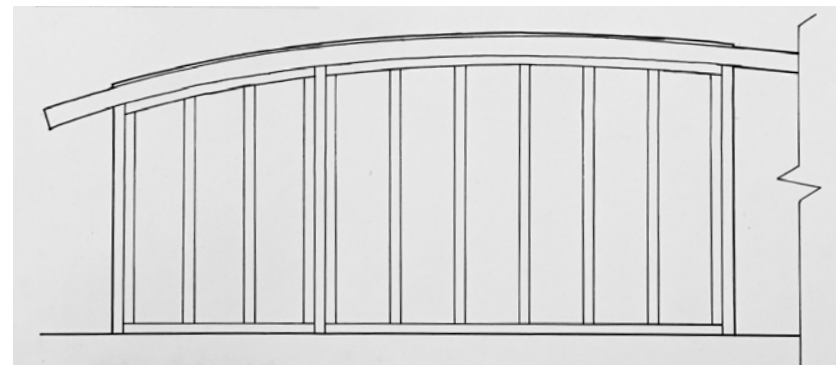

NORTH ELEVATION

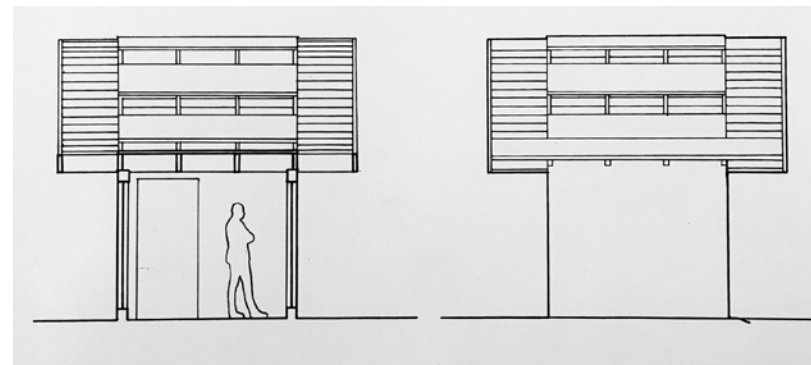

WEST SECTION

WEST ELEVATION

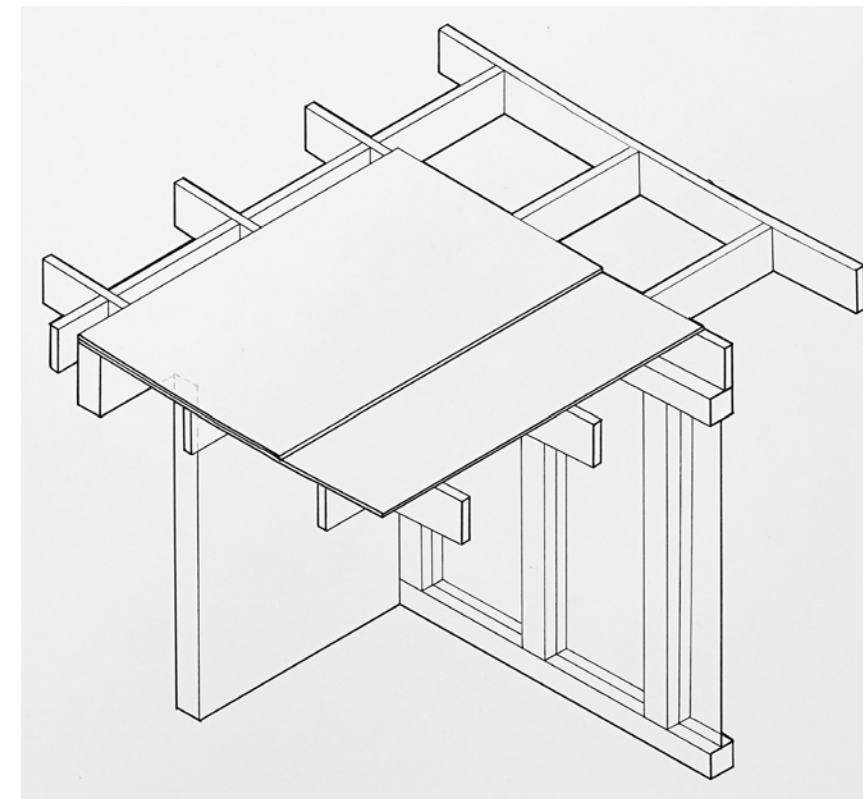

AXONOMETRIC SECTION

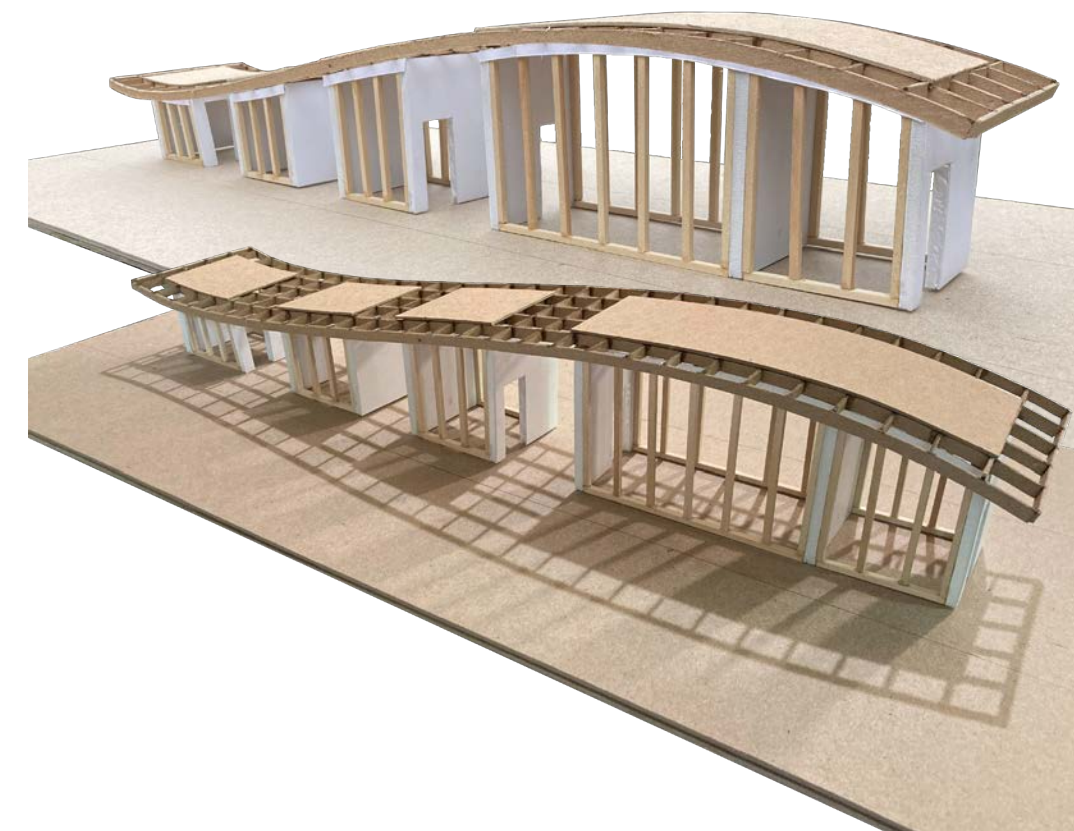



Jinwa Mountain Cottage Precedent Study DCOM 2

This class was a pivotal moment in my development as a designer, as it helped me build both my technical and communication skills. Through this class, I had the opportunity to learn a wide range of advanced software and techniques, allowing me to create several types of drawings that have proven invaluable in my work. From precise technical drawings to artistic renderings, I now have a wide range of tools at my disposal to effectively communicate my design vision to others.

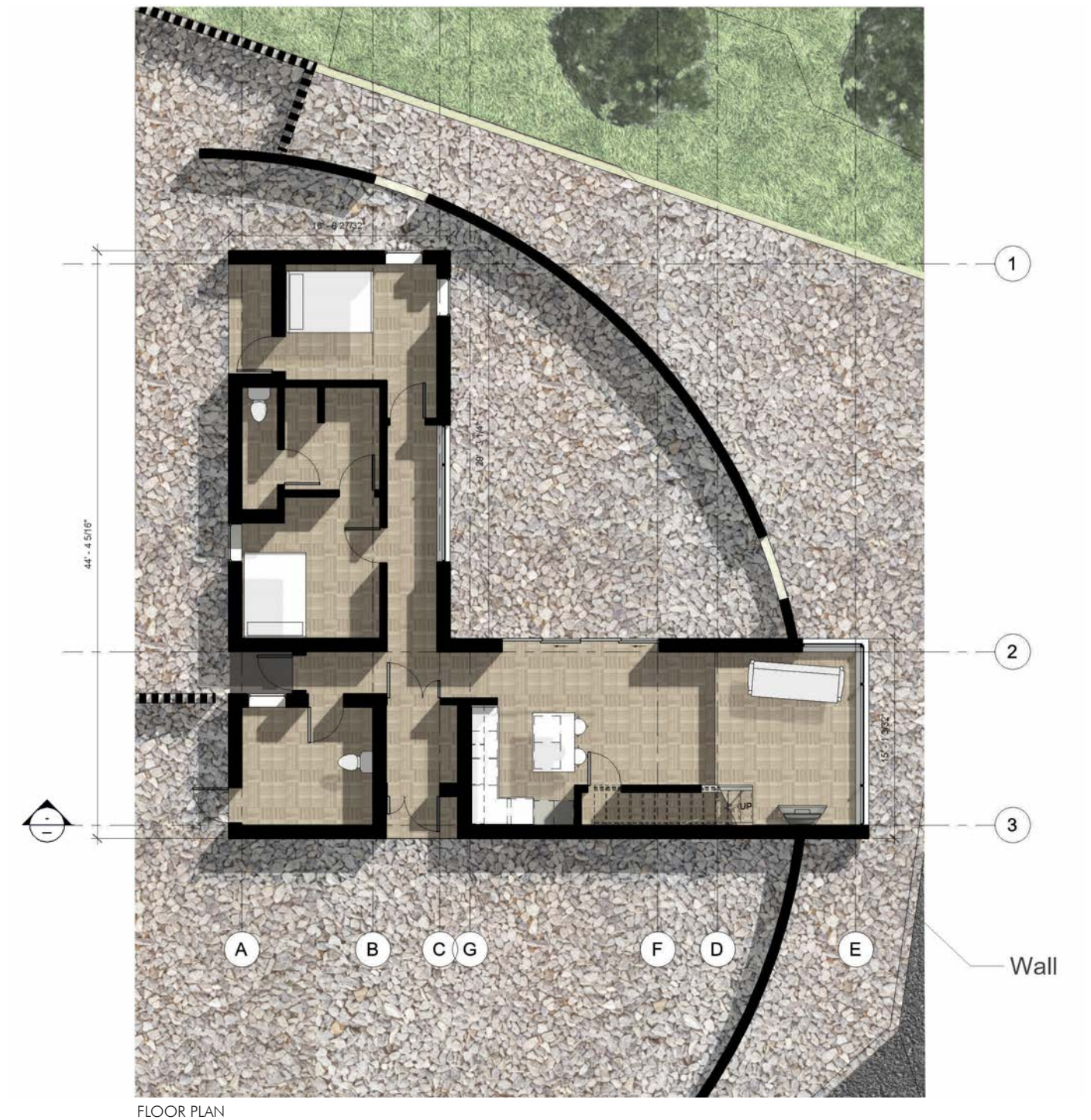

I had the opportunity to study the Jinwa Mountain Cottage precedent as a technical drawing precedent. Through this study, I was able to examine the intricate details of the cottage's construction, from its structural framework to its plumbing and electrical systems. By studying this precedent, I gained a deeper understanding of how to create technical drawings that accurately convey the details of a building's design.

I am incredibly proud of this rendered work because it is a powerful reflection of the skills I developed in my design class. Through this class, I learned a wide range of skills, including how to use advanced software and rendering techniques to create stunning visualizations of my designs



AXONOMETRIC DIAGRAM

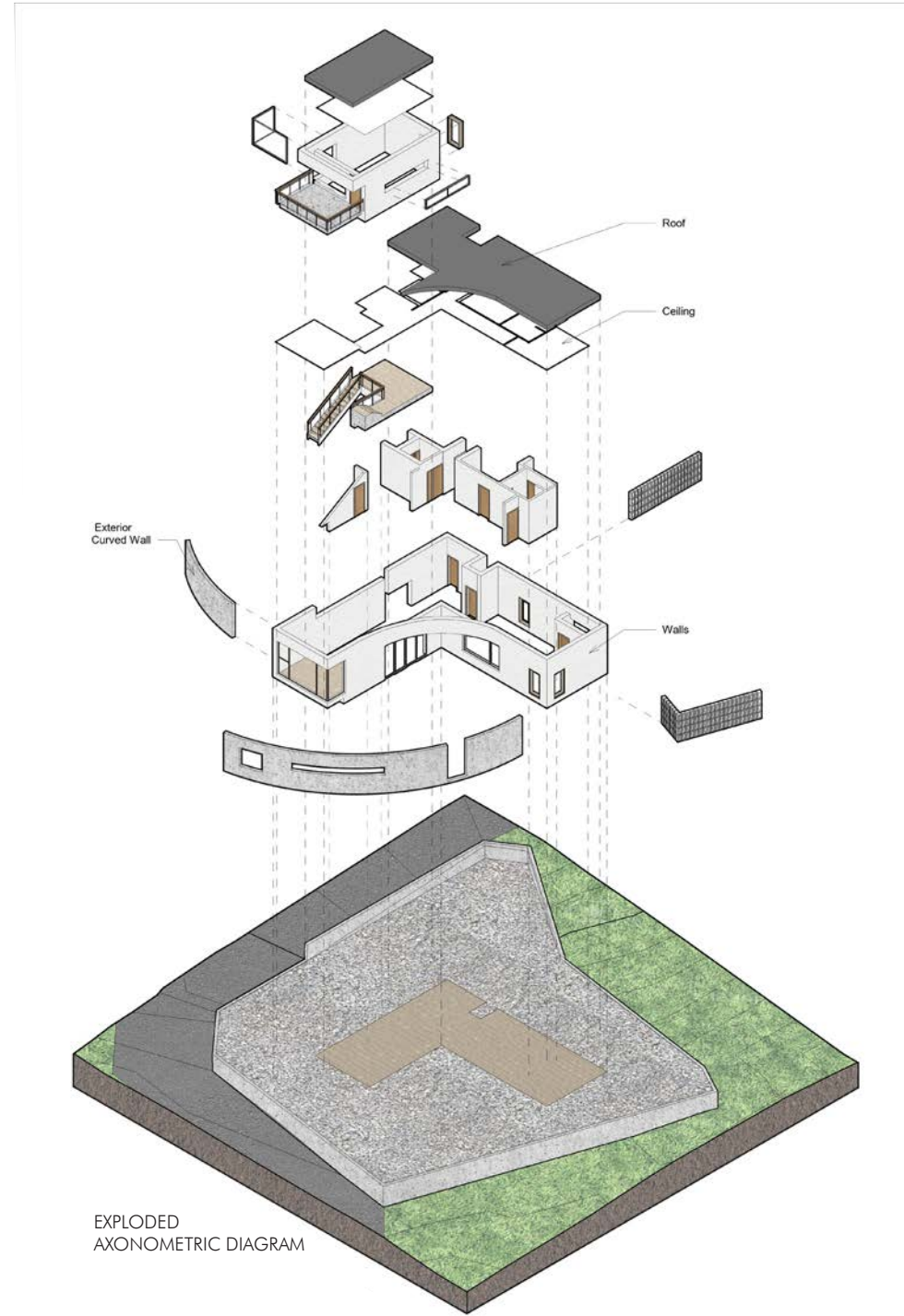

EXPLODED AXONOMETRIC DIAGRAM

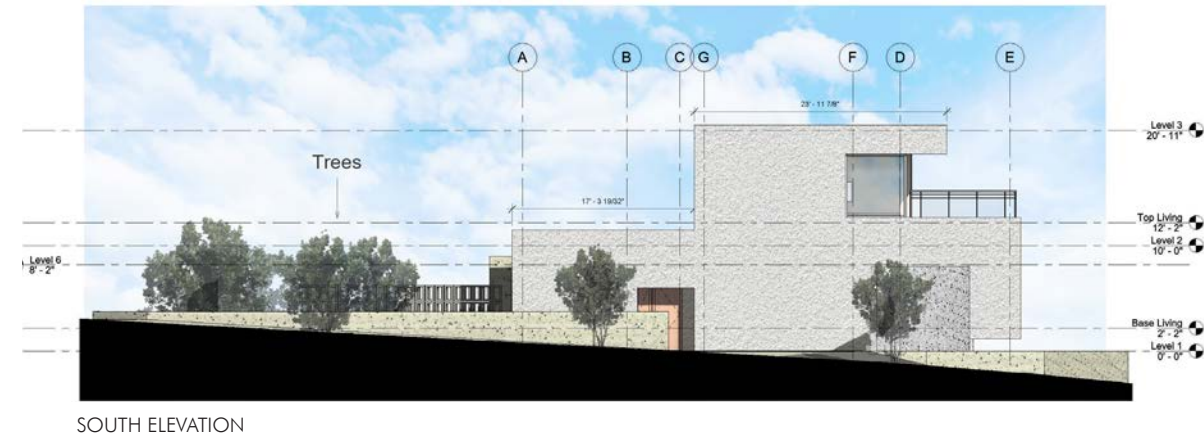

SOUTH ELEVATION



SOUTH SECTION

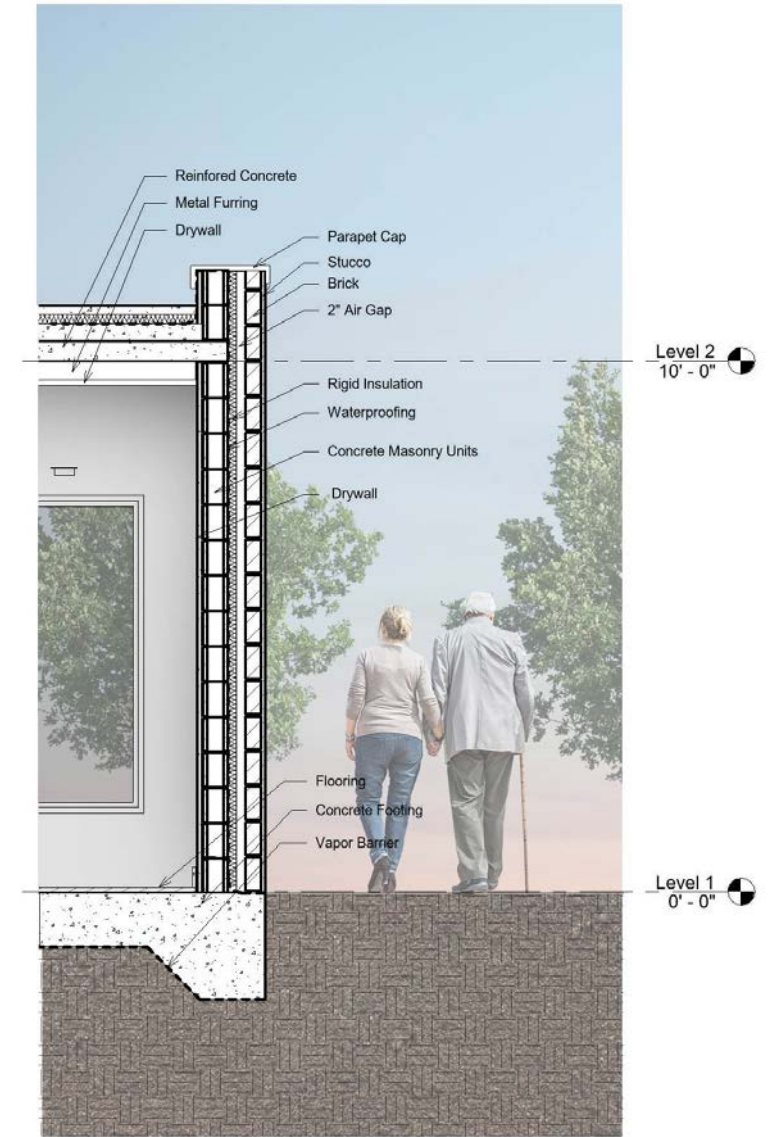

WALL DETAIL



MultiFamily Development Studio 3

This course builds on the design thinking skills developed during first year studios. This course initiates the application of research from site, context and case studies in the design process and emphasizes design concept development. Projects initiate the design of interior and exterior conditions, site design and the architectural design of structural systems.

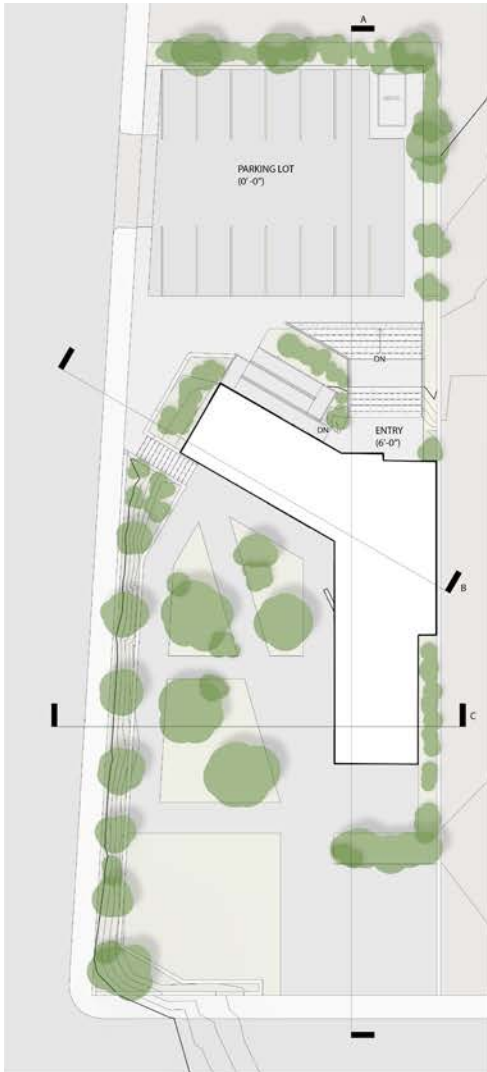
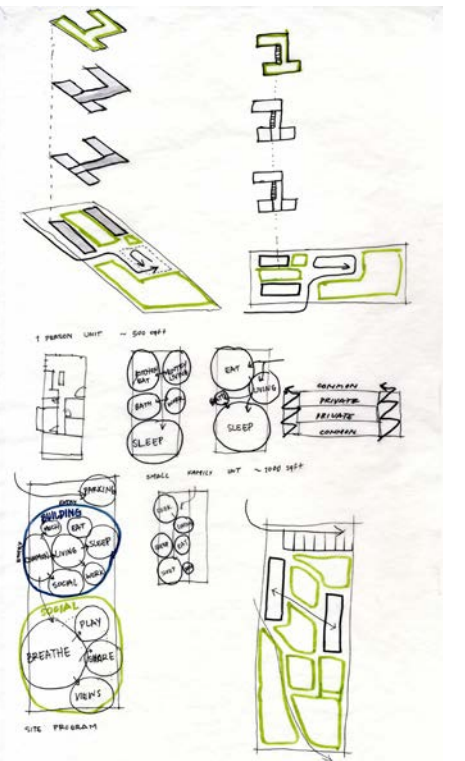
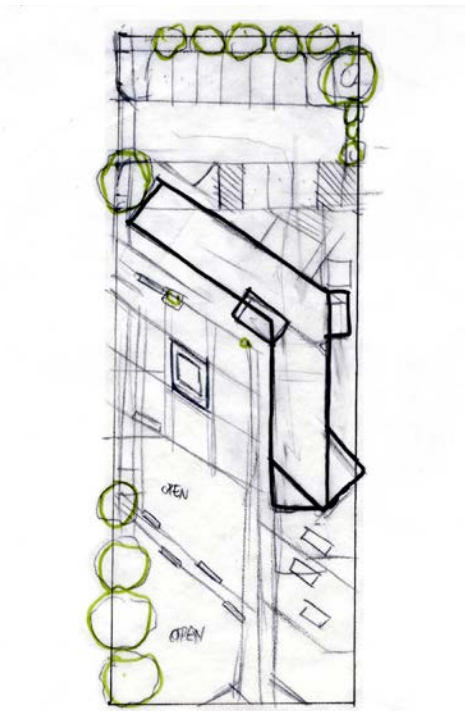

SITE PLAN

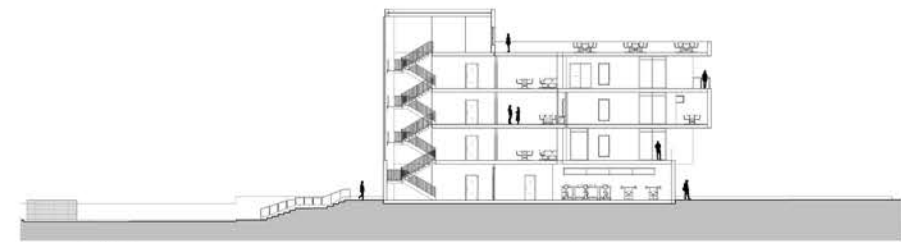

SECTION A

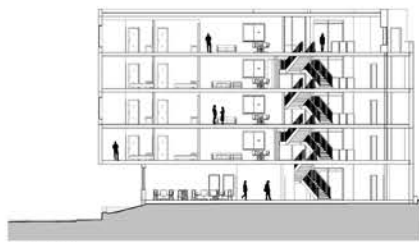

SECTION B



WEST ELEVATION

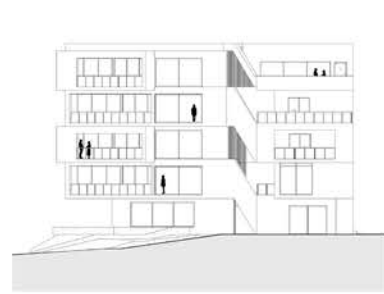

SOUTH ELEVATION

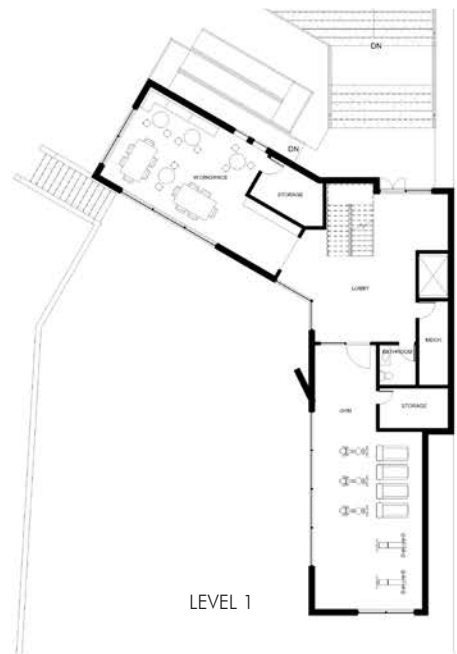
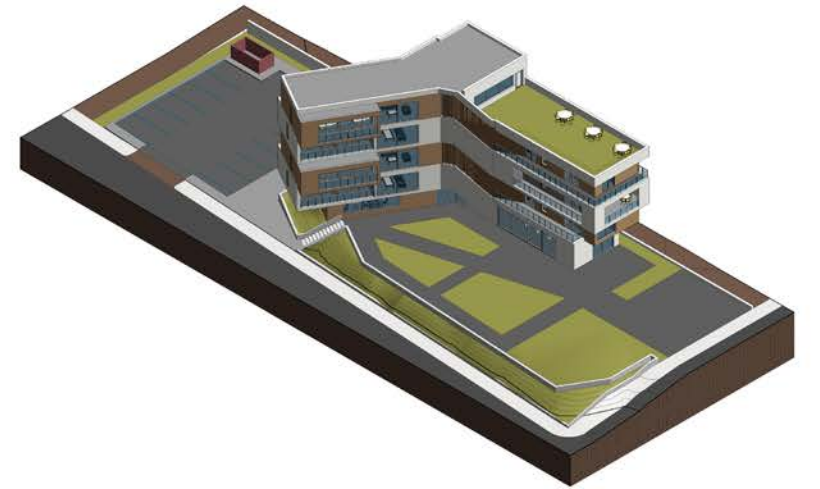

LEVEL 1



LEVEL 2

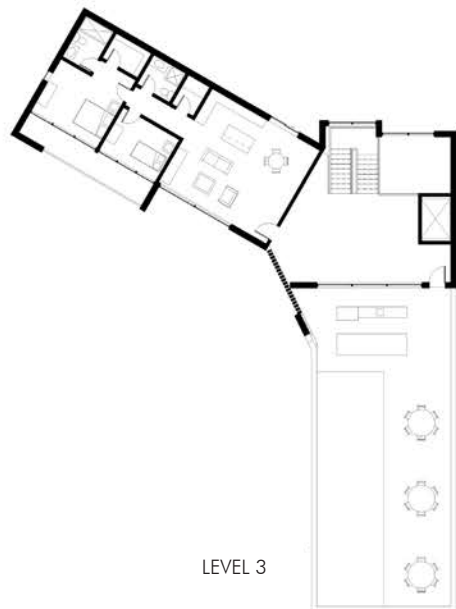

LEVEL 3

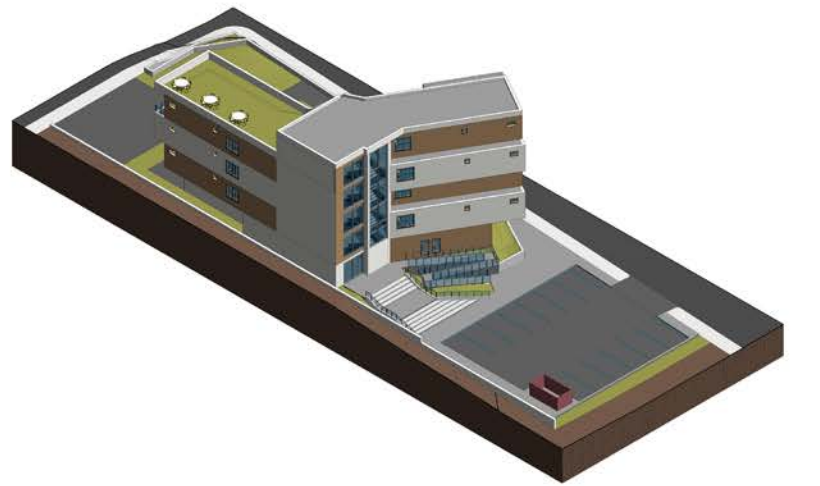



Marietta Square Pavillion Studio IV

This assignment focuses on applying research knowledge gained through precedent studies as students design a structural system to respond to program and site. Students will select one precedent to research and use the knowledge gained in designing a prototypical condition for their project's structural system.

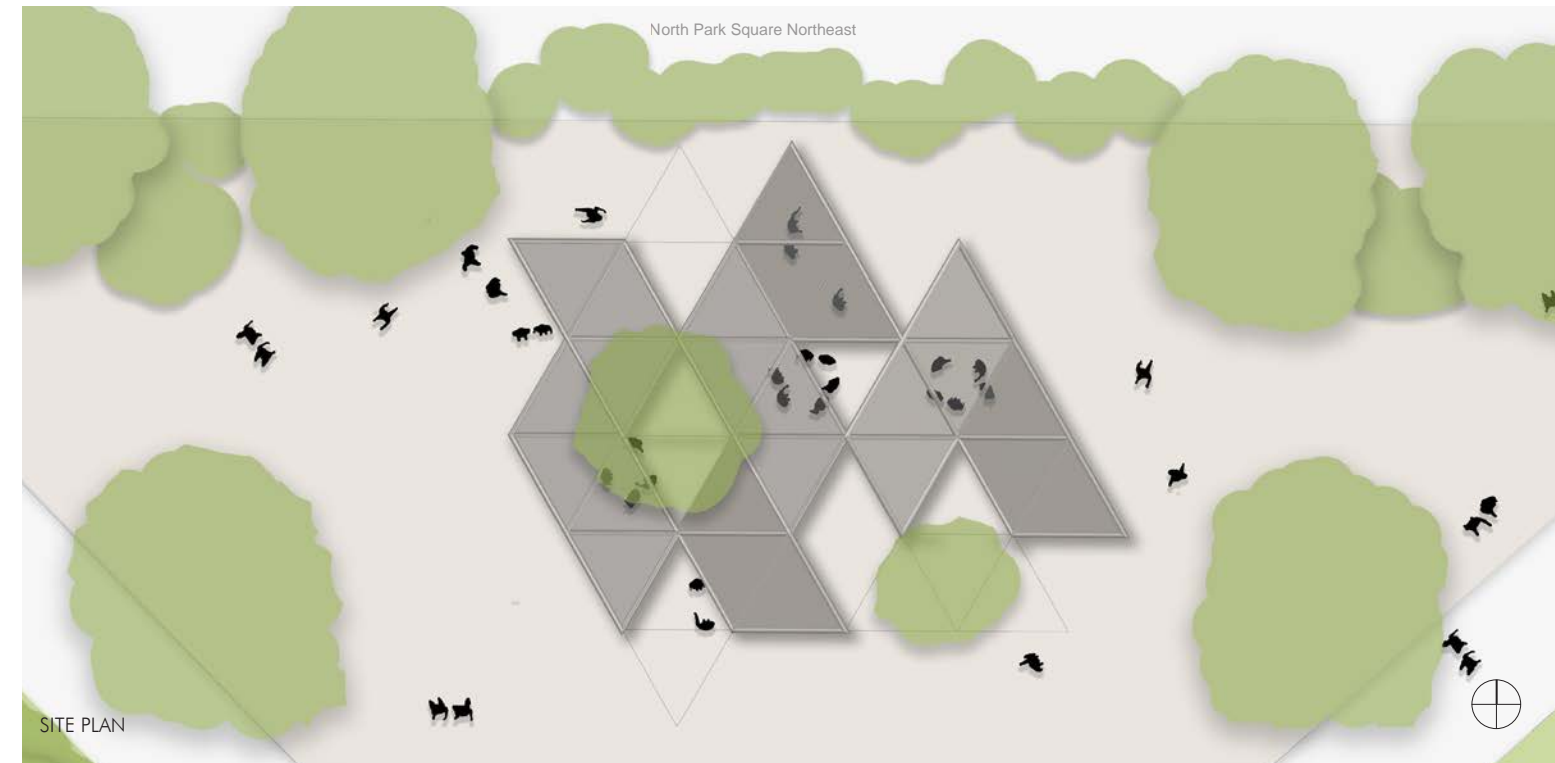
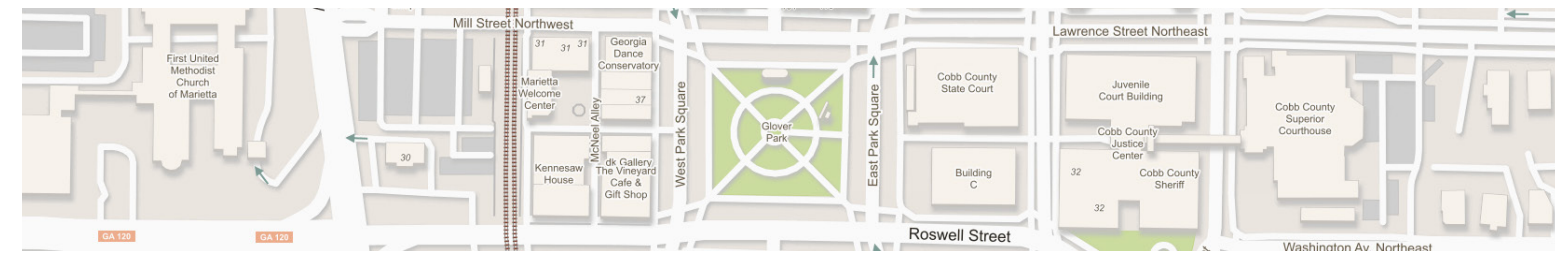

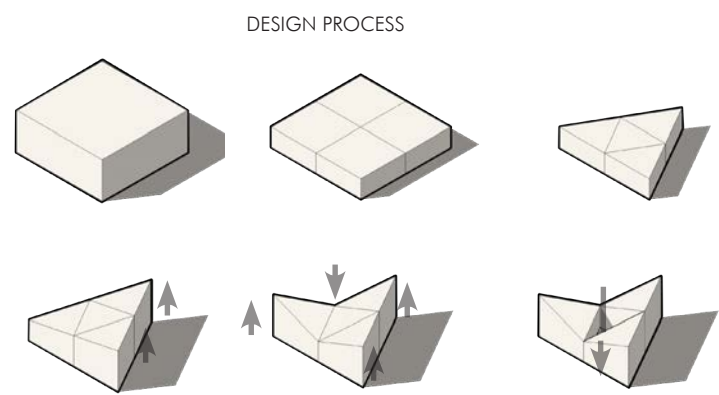
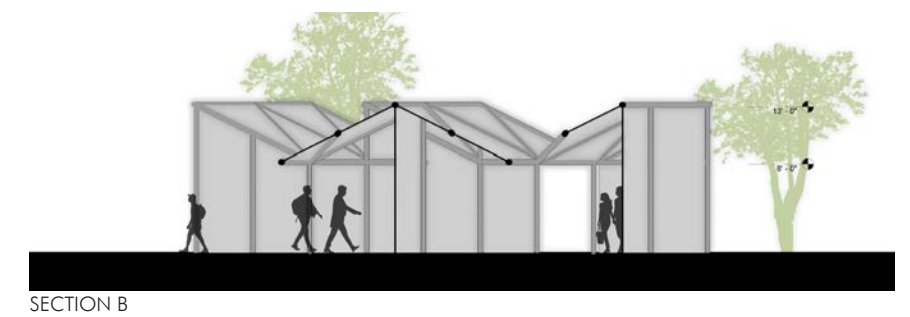
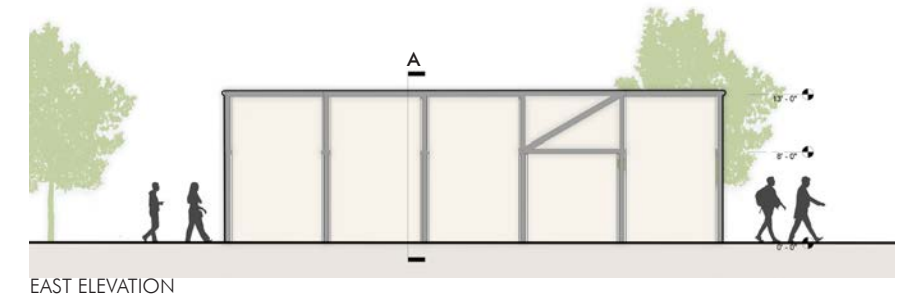
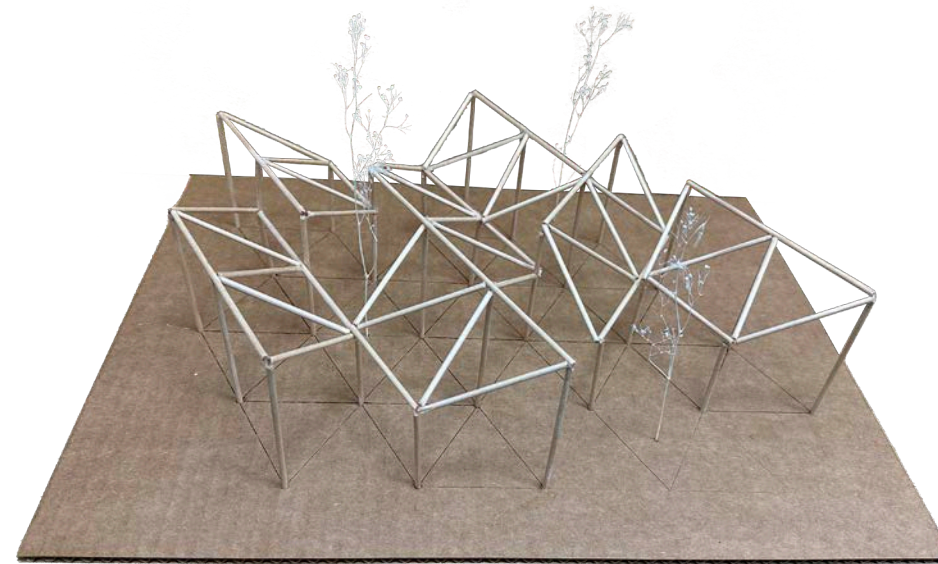
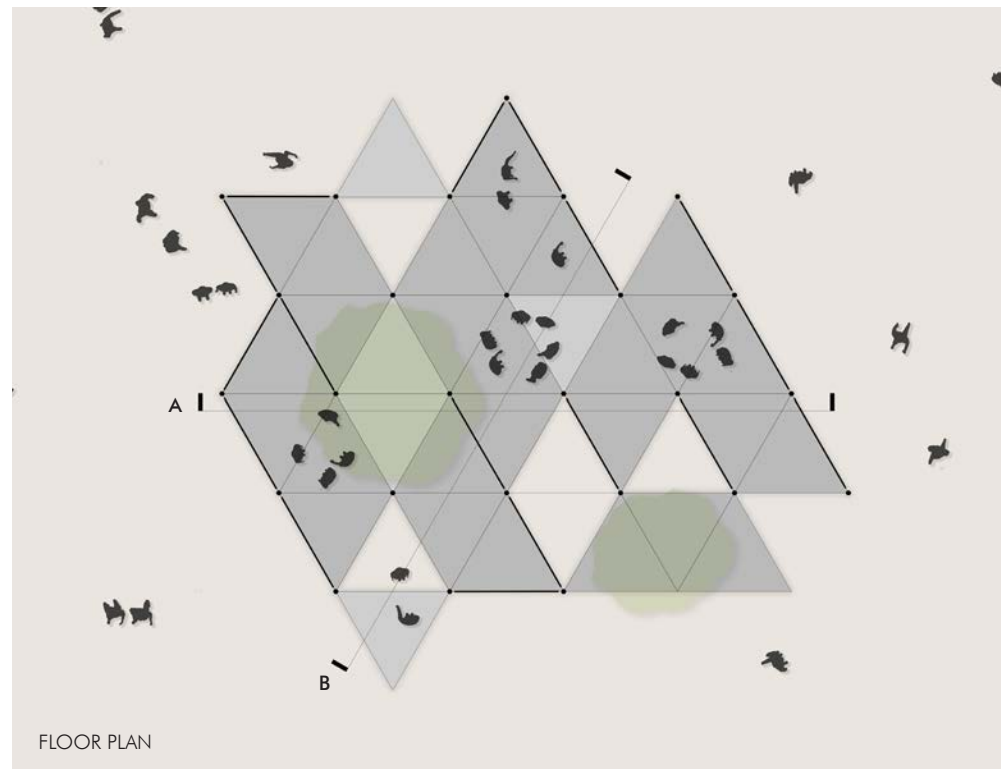
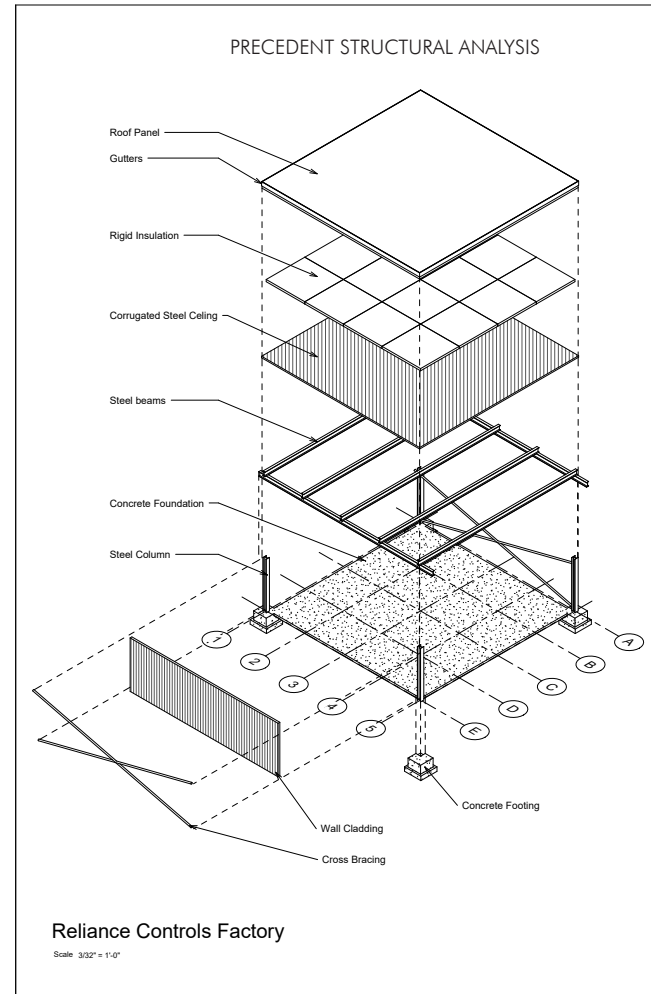



Izakaya Restaurant Studio IV

We were challenged to design a theme based full service restaurant at the intersection of Whitlock Avenue and The Marietta Loop, next to the Marietta Square. Theme restaurants are restaurants in which the idea for the restaurant takes priority over everything else. It influences the architecture, food, music, and overall “feel” of the restaurant. It is the overall idea or theme that defines the restaurant. My restaurant explores the theme of izakaya style restaurants



SITE ANALYSIS

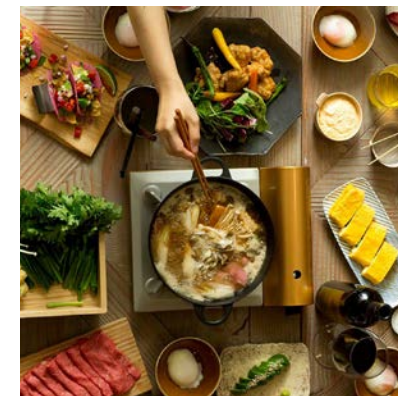

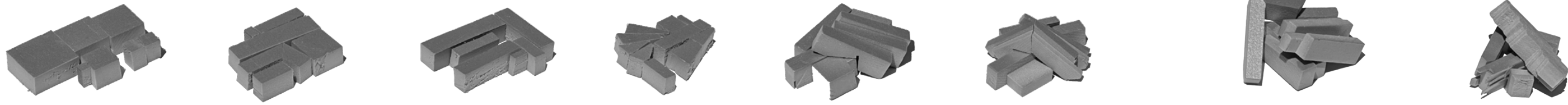

To explore the form of a restaurant design, I used mass models to create a concept for a restaurant project. The purpose of using mass models was to experiment with different shapes and configurations, and to develop a strong understanding of how the form of the building can influence its function.

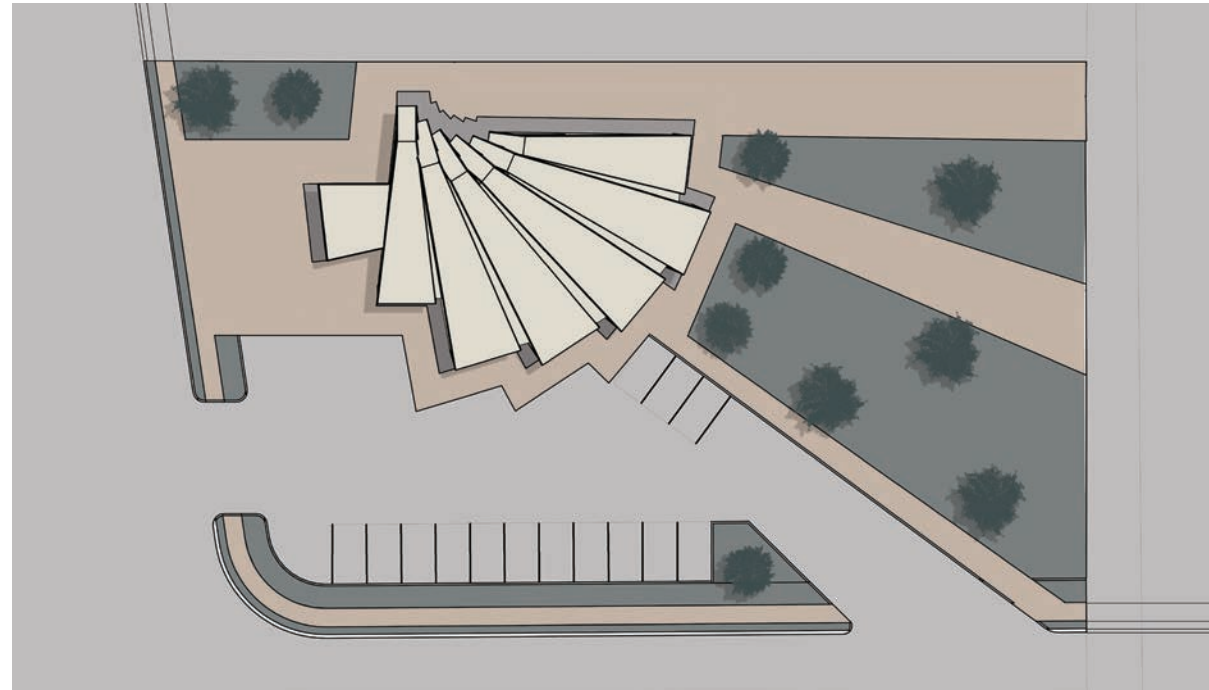

SITE PLAN

I also explored various materials to determine the most appropriate choices for the building's design. This involved researching the properties and characteristics of different materials, as well as considering their visual and textural qualities.



MATERIAL STUDY MODELS

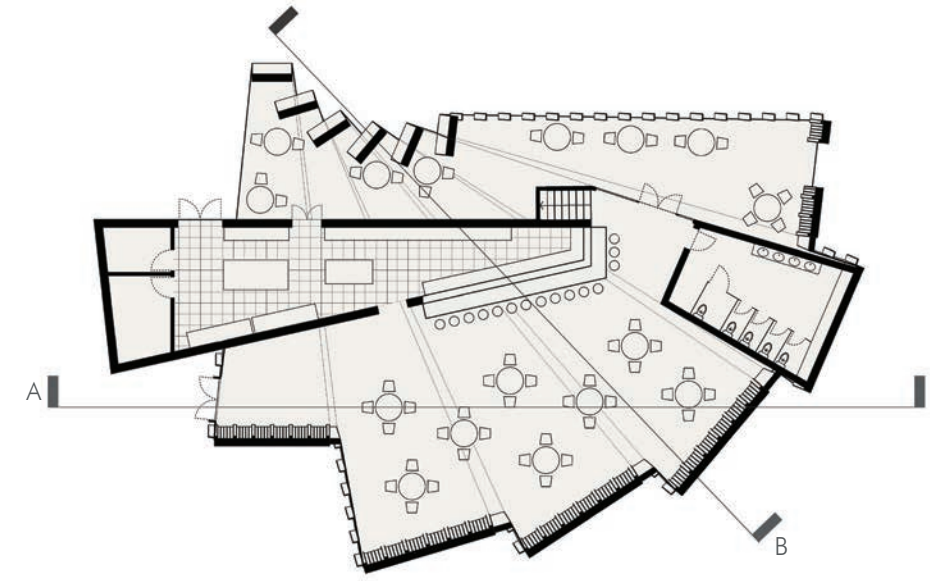

1ST FLOOR PLAN

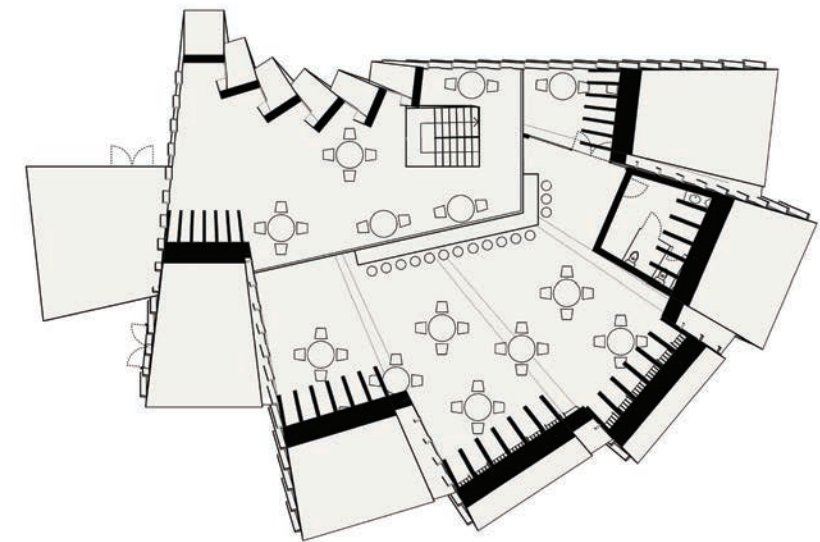

2ND FLOOR PLAN

DESIGN PROCESS

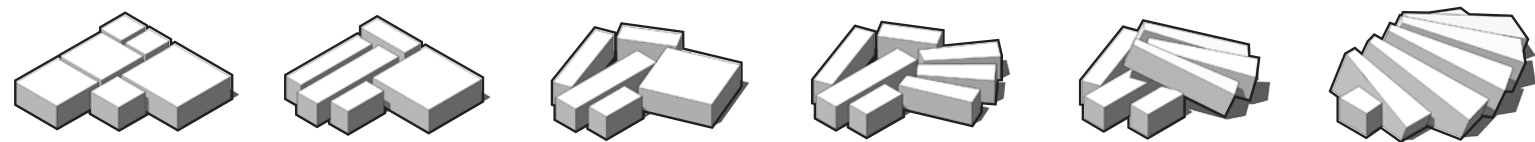

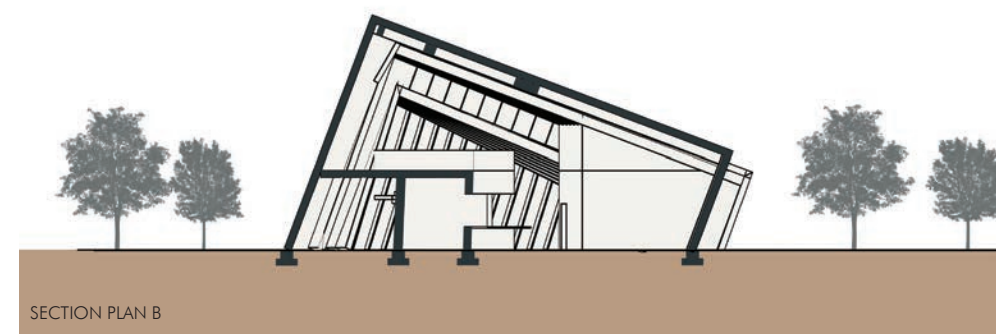
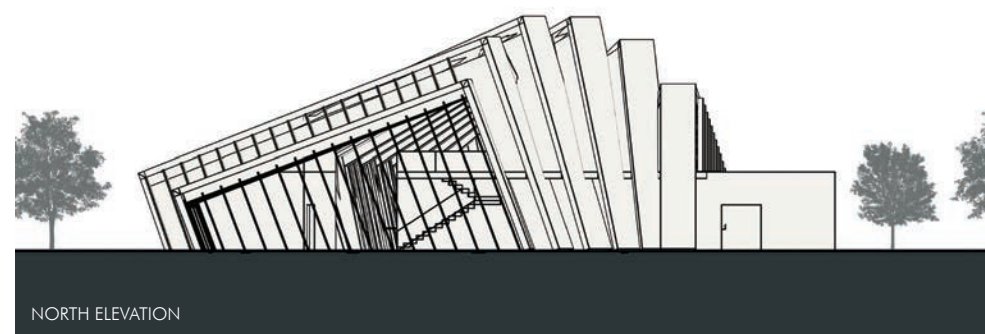
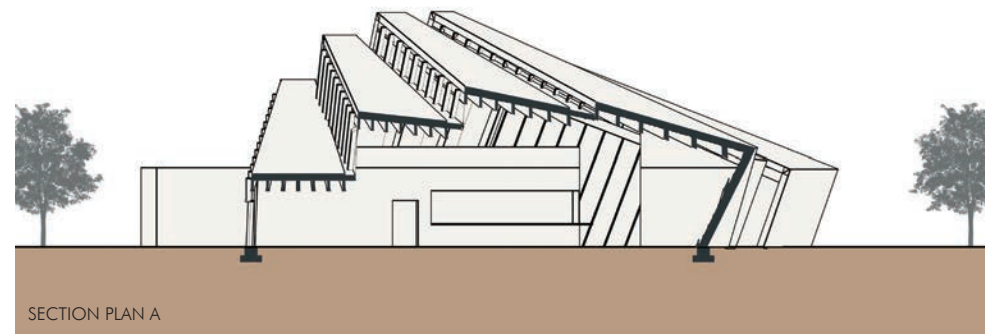
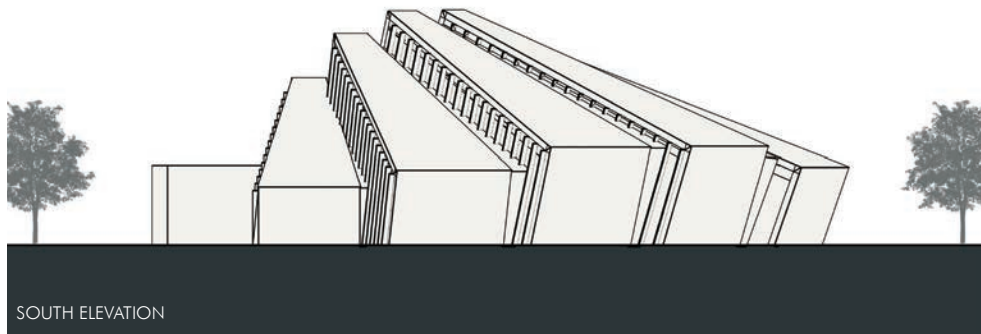



Fernando Botero Gallery Studio IV

The project I worked on was a mixed-use artist studio and gallery located in Marietta. My assignment was to design a facility that provided artists with studio and exhibition space, while also fostering public engagement with the arts. To pay homage to Fernando Botero, I incorporated multiple swollen volumes in the design, similar to his iconic sculptures. The resulting building not only provides a functional space for artists to create and showcase their work, but also serves as a visual landmark that celebrates the power of Botero's art.

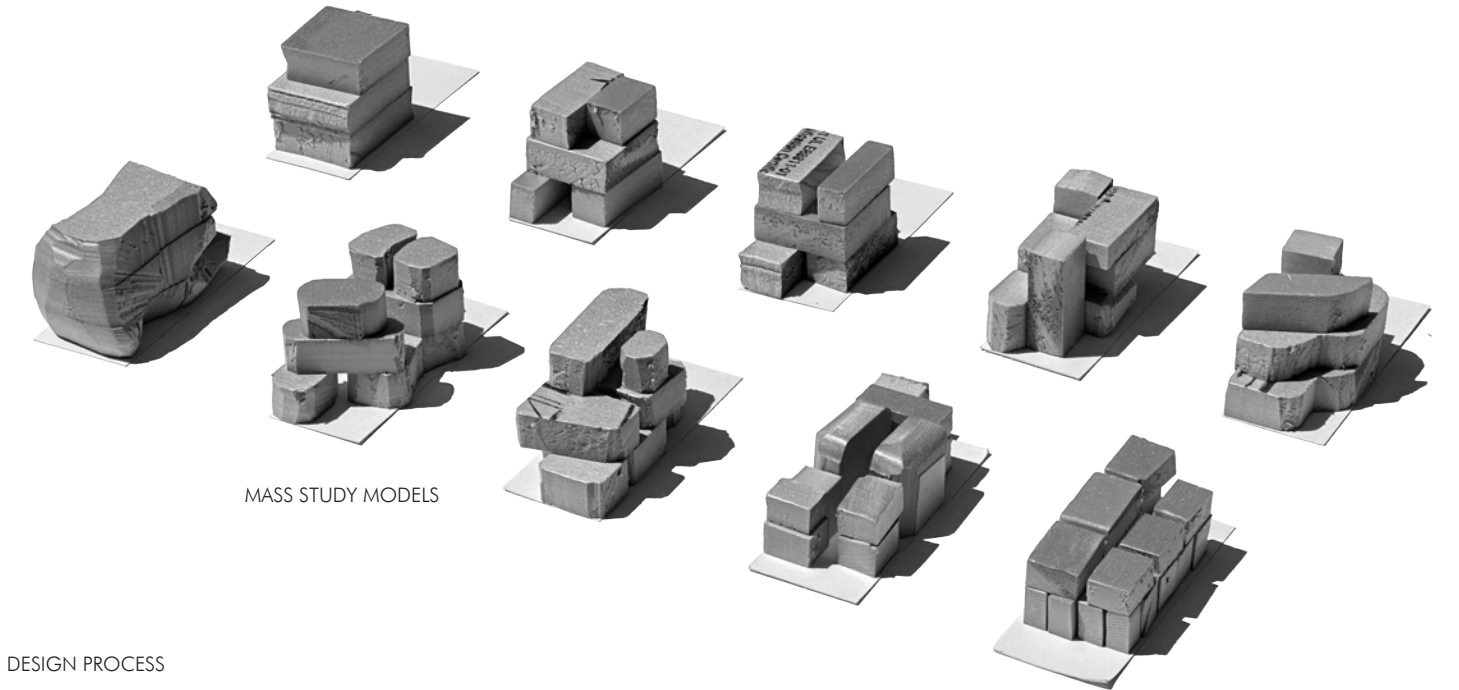

DESIGN PROCESS

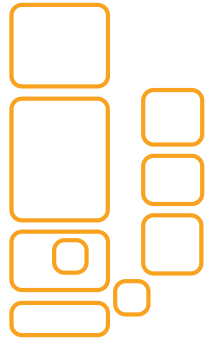
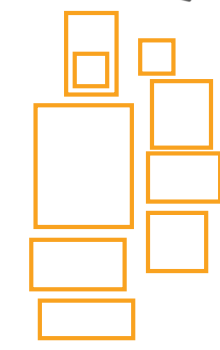
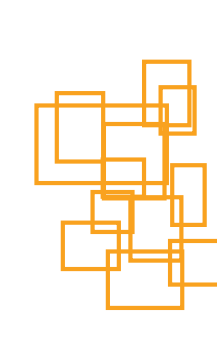
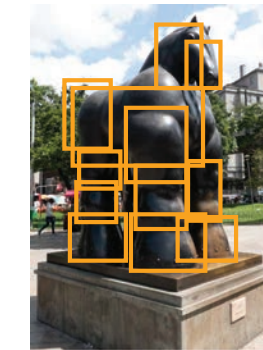

SITE ANALYSIS TO SITE PLAN

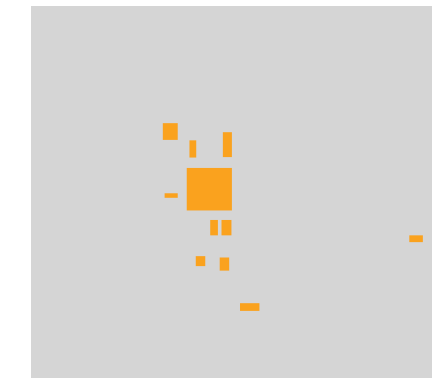

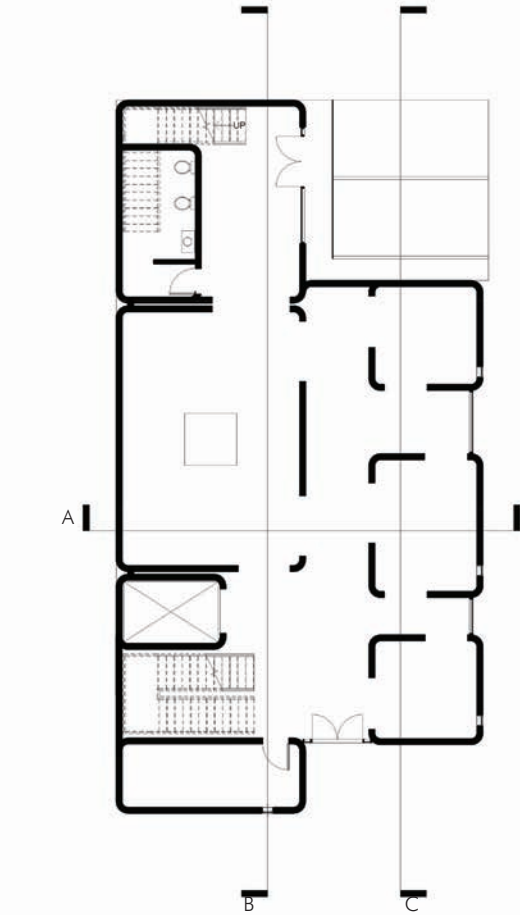

1ST FLOOR PLAN

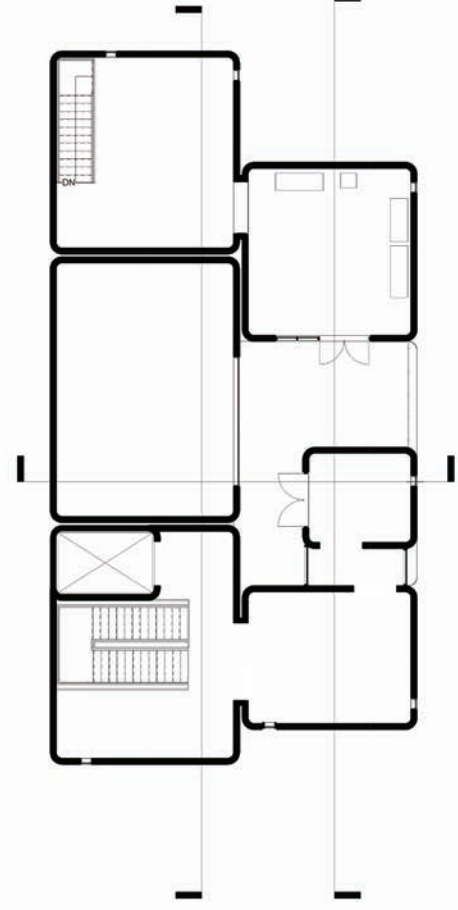

2ND FLOOR PLAN



SOUTH ELEVATION

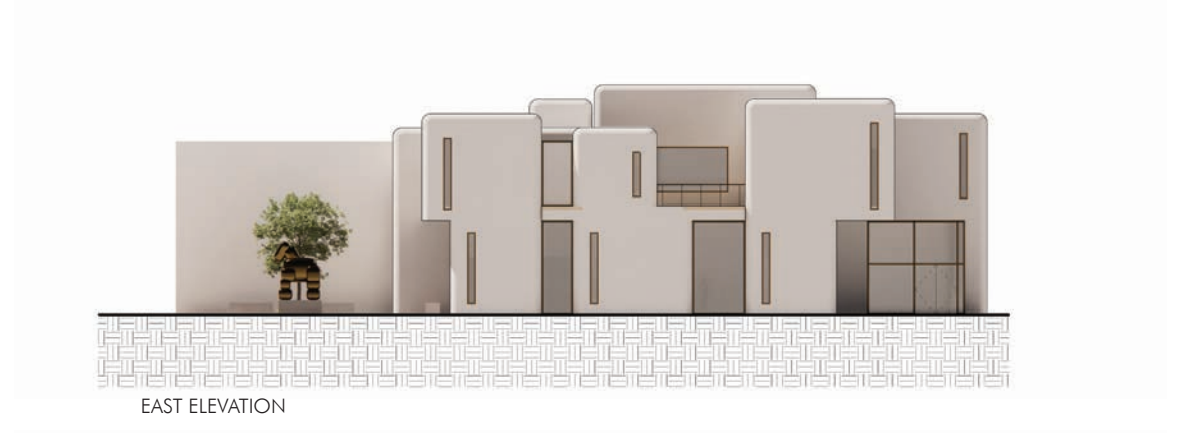

EAST ELEVATION



SECTION A



SECTION B





AXONOMETRIC RENDER

**“Architecture forms a vital link between
people and their surroundings”**
- Kengo Kuma